

OVERALL LAYOUT

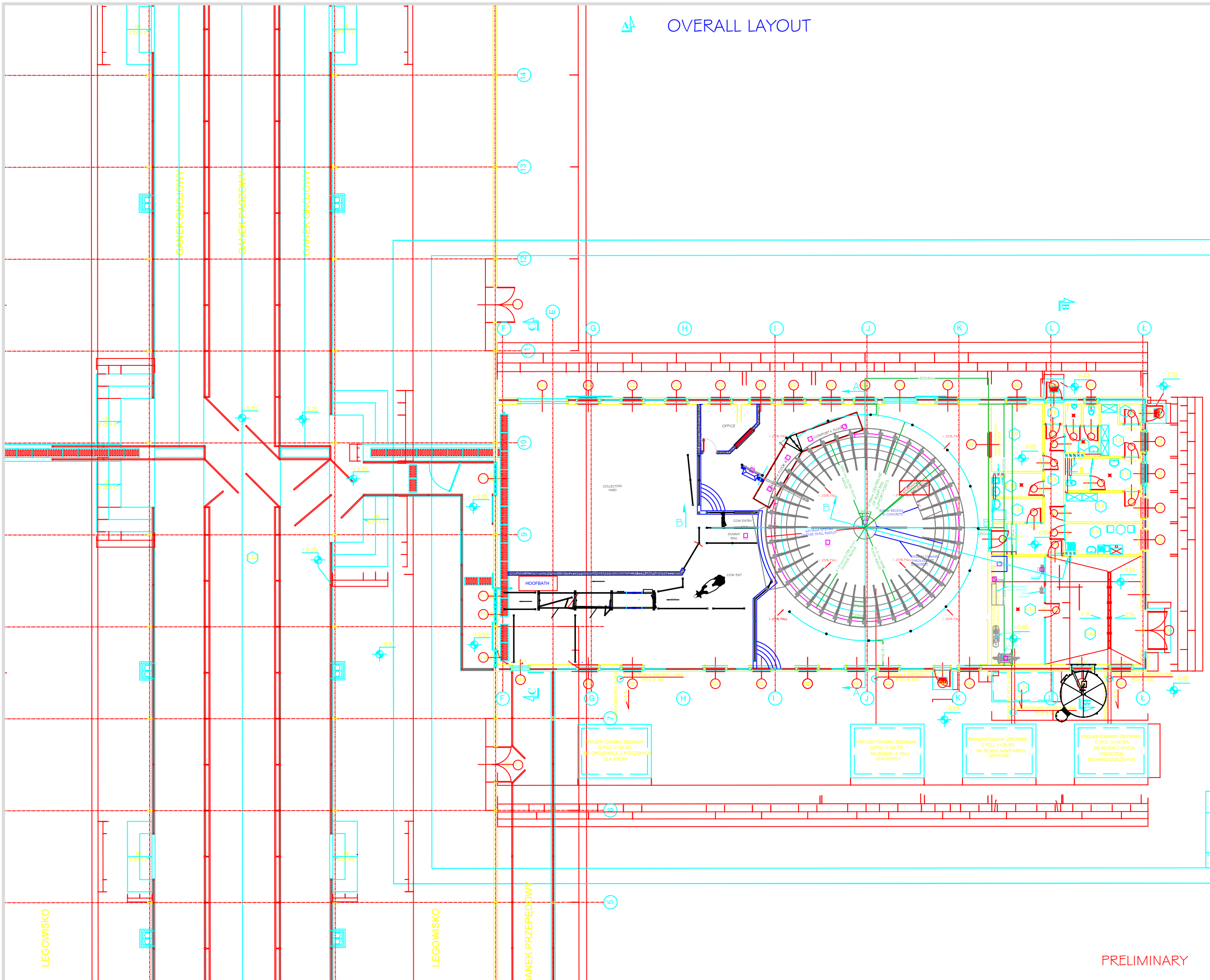

**IMPORTANT**  
 Compliance with construction regulations applicable to this project is the sole and exclusive responsibility of the client.  
 Compliance with health and safety regulations applicable to this project is the sole and exclusive responsibility of the client.  
 The appointment of a principal designer applicable to this project and in compliance with regulations is the sole and exclusive responsibility of the client.

These plans and constructed facility are subject to various building codes, standards, ordinances and regulations. Compliance with such codes, standards, ordinances and regulations is your sole and exclusive responsibility. Prior to beginning any construction all dimensions and specifications should be examined and approved by a locally registered engineer and architect.

These plans are furnished as one example of a milking system. The system depicted may not be the most efficient or economical for you. Dairymaster makes no representation of or warranties, expressed or implied as to the efficiency of the system depicted in these plans or its appropriateness for use in your dairy business.

It is your responsibility to conduct a safety risk assessment & ensure safe systems of work on this facility both during construction & operation. These drawings may be only used for locating equipment for installation, all structural design, equipotential bonding and other functional requirements shall be the responsibility of the client.

Dairymaster accepts no responsibility for errors and omissions.

**NOTES:**

- Do not scale.
- Drainage and gullies in parlour, wash room and dairy to be positioned and installed by builder.
- Ensure all post are vertical and plum.
- Double check that the post measurements are correct at both the top and cow stand.
- 1.5% Slope = 1 IN 66.67
- 2.5% Slope = 1 IN 40

**NOTE:**

Production of parlour cannot commence until the drawings are confirmed

**DAIRYMASTER**  
  
 Experience the difference  
[www.dairymaster.com](http://www.dairymaster.com)  
 Tel: +353 66 7131124  
 Email: [design@dairymaster.com](mailto:design@dairymaster.com)

**OHZ Garzyn**  
 Leszczynska 34  
 62-120  
 Garzyn

Country: Poland

Dealer or Sales Rep:  
 Dairymaster BV

Drawing Number: PD00-001022-000.dwg  
 Rev: R1  
 Sht No: 1

Drawn By: Pdraig Harty

Sales Order #:

No Units: 40

Parlour Type:

Swiftflo Revolver - Clockwise

PRELIMINARY

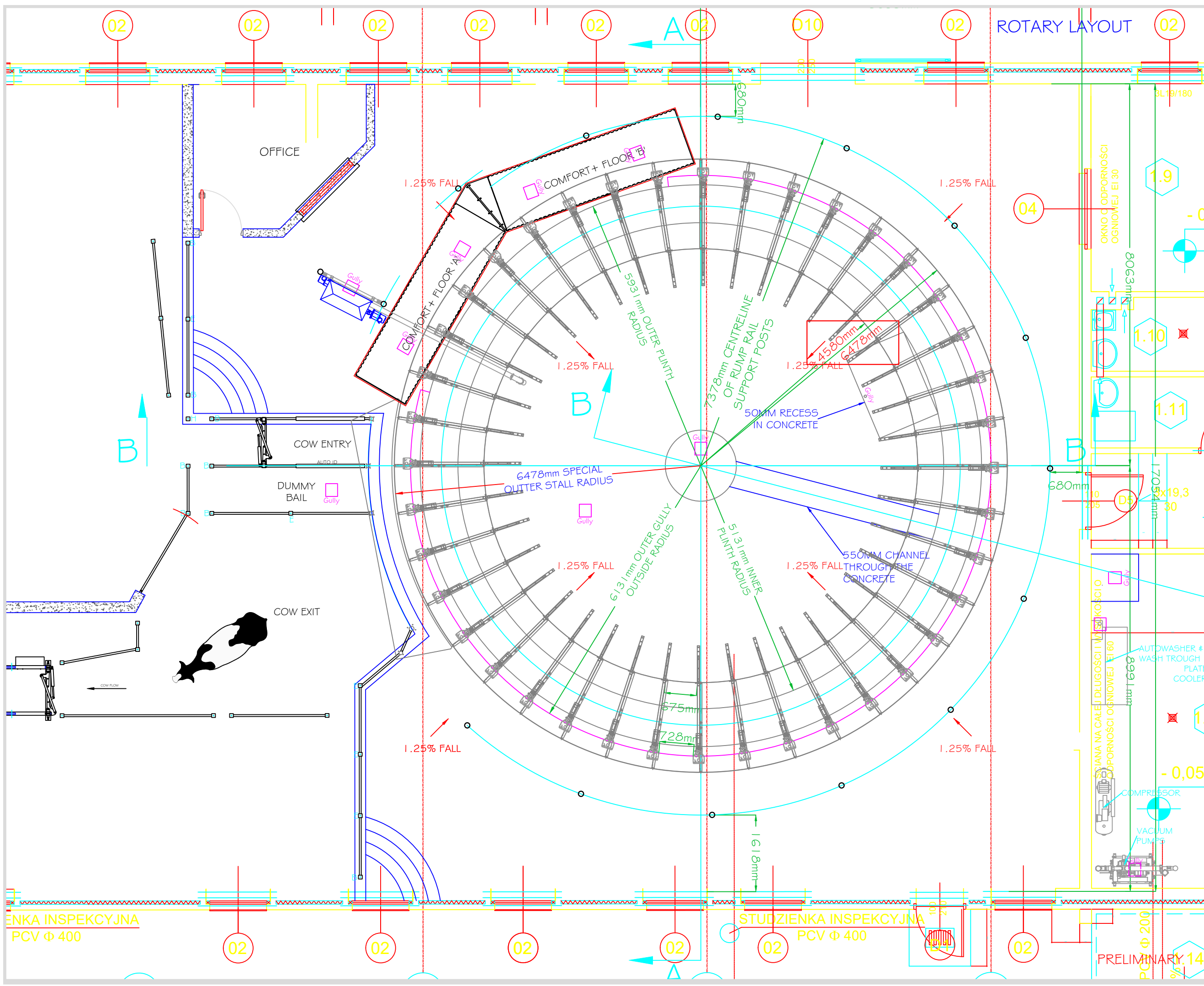

**IMPORTANT**  
 Compliance with construction regulations applicable to this project is the sole and exclusive responsibility of the client. Compliance with health and safety regulations applicable to this project is the sole and exclusive responsibility of the client. The appointment of a principal designer applicable to this project and in compliance with regulations is the sole and exclusive responsibility of the client.

These plans and constructed facility are subject to various building codes, standards, ordinances and regulations. Compliance with such codes, standards, ordinances and regulations is your sole and exclusive responsibility. Prior to beginning any construction all dimensions and specifications should be examined and approved by a locally registered engineer and architect.

These plans are furnished as one example of a milking system. The system depicted may not be the most efficient or economical for you. DairyMaster makes no representation of or warranties, expressed or implied as to the efficiency of the system depicted in these plans or its appropriateness for use in your dairy business.

It is your responsibility to conduct a safety risk assessment & ensure safe systems of work on this facility both during construction & operation. These drawings may be only used for locating equipment for installation, all structural design, equipotential bonding and other functional requirements shall be the responsibility of the client.

DairyMaster accepts no responsibility for errors and omissions.

- NOTES:**
- Do not scale.
  - Drainage and gullies in parlour, wash room and dairy to be positioned and installed by builder.
  - Ensure all post are vertical and plum.
  - Double check that the post measurements are correct at both the top and cow stand.
  - 1.5% Slope = 1 IN 66.67
  - 2.5% Slope = 1 IN 40

**NOTE:**  
 Production of parlour cannot commence until the drawings are confirmed

**DAIRYMASTER**  
  
 Experience the difference  
[www.dairymaster.com](http://www.dairymaster.com)  
 Tel: +353 66 7131124  
 Email: [design@dairymaster.com](mailto:design@dairymaster.com)

**OHZ Garzyn**  
 Leszczynska 34  
 62-120  
 Garzyn

Country: Poland  
 Dealer or Sales Rep:  
 DairyMaster BV

Drawing Number: PD00-001022-000.dwg  
 Rev: R1  
 Sht No: 2

Drawn By: Padraig Harty

Sales Order #:

No Units: 40

Parlour Type:  
 Swiftflo Revolver - Clockwise

ENKA INSPEKCYJNA  
 PCV Φ 400

STUDZIENKA INSPEKCYJNA  
 PCV Φ 400

PRELIMINARY 14

# CROSS SECTION A A

- IMPORTANT:**
1. ROTARY TABLE, ENTRY BRIDGE & ALL STALLWORK MUST BE INSTALLED BY DAIRYMASTER BEFORE THE ENTRY BRIDGE FINISHED FLOOR IS LAID.
  2. FIBRE REINFORCED CONCRETE TO BE USED IN PLINTH & ENTRY DECK.

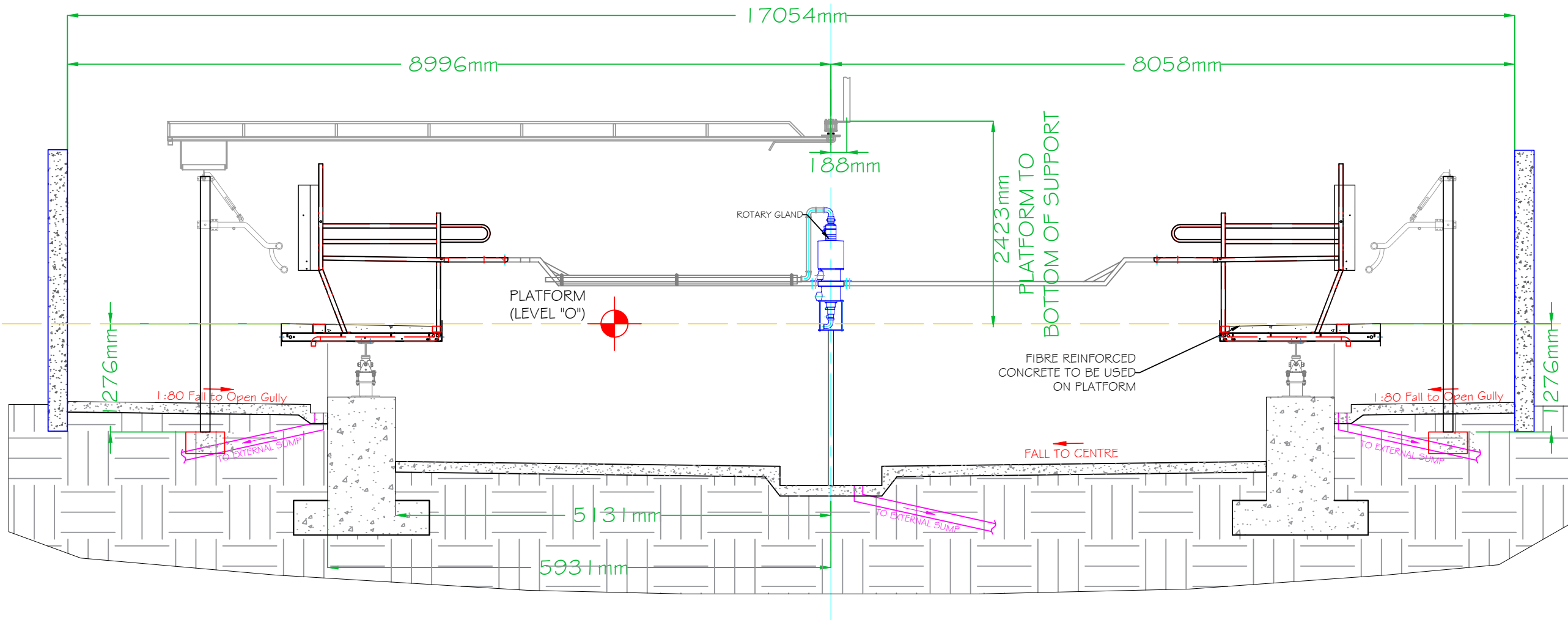

**NOTE:** ALL STRUCTURAL DETAILS, INCLUDING FOUNDATION SIZE AND DEPTH MUST BE DETERMINED BY A QUALIFIED ENGINEER

# CROSS SECTION A-A

**IMPORTANT**  
 Compliance with construction regulations applicable to this project is the sole and exclusive responsibility of the client.  
 Compliance with health and safety regulations applicable to this project is the sole and exclusive responsibility of the client.  
 The appointment of a principal designer applicable to this project and in compliance with regulations is the sole and exclusive responsibility of the client.

These plans and constructed facility are subject to various building codes, standards, ordinances and regulations. Compliance with such codes, standards, ordinances and regulations is your sole and exclusive responsibility. Prior to beginning any construction all dimensions and specifications should be examined and approved by a locally registered engineer and architect.

These plans are furnished as one example of a milking system. The system depicted may not be the most efficient or economical for you. Dairymaster makes no representation of or warranties, expressed or implied as to the efficiency of the system depicted in these plans or its appropriateness for use in your dairy business.

It is your responsibility to conduct a safety risk assessment & ensure safe systems of work on this facility both during construction & operation. These drawings may be only used for locating equipment for installation, all structural design, equipotential bonding and other functional requirements shall be the responsibility of the client.

Dairymaster accepts no responsibility for errors and omissions.

**NOTES:**

- Do not scale.
- Drainage and gullies in parlour, wash room and dairy to be positioned and installed by builder.
- Ensure all post are vertical and plum.
- Double check that the post measurements are correct at both the top and cow stand.
- 1.5% Slope = 1 IN 66.67
- 2.5% Slope = 1 IN 40

**NOTE:**

Production of parlour cannot commence until the drawings are confirmed

**DAIRYMASTER**  
 Experience the difference  
[www.dairymaster.com](http://www.dairymaster.com)  
 Tel: +353 66 7131124  
 Email: [design@dairymaster.com](mailto:design@dairymaster.com)

**OHZ Garzyn**

Leszczynska 34  
 62-120  
 Garzyn

Country: Poland

Dealer or Sales Rep:  
 Dairymaster BV

Drawing Number: PD00-001022-000.dwg	Rev: R1 Sht No: 3
--	----------------------

Drawn By: Padraig Harty

Sales Order #:

No Units: 40

Parlour Type:

Swiftflo Revolver - Clockwise

PRELIMINARY



# CROSS SECTION B B

**IMPORTANT:**  
 1. ROTARY TABLE, ENTRY BRIDGE & ALL STALLWORK MUST BE INSTALLED BY DAIRYMASTER BEFORE THE ENTRY BRIDGE FINISHED FLOOR IS LAID.  
 2. FIBRE REINFORCED CONCRETE TO BE USED IN PLINTH & ENTRY DECK.

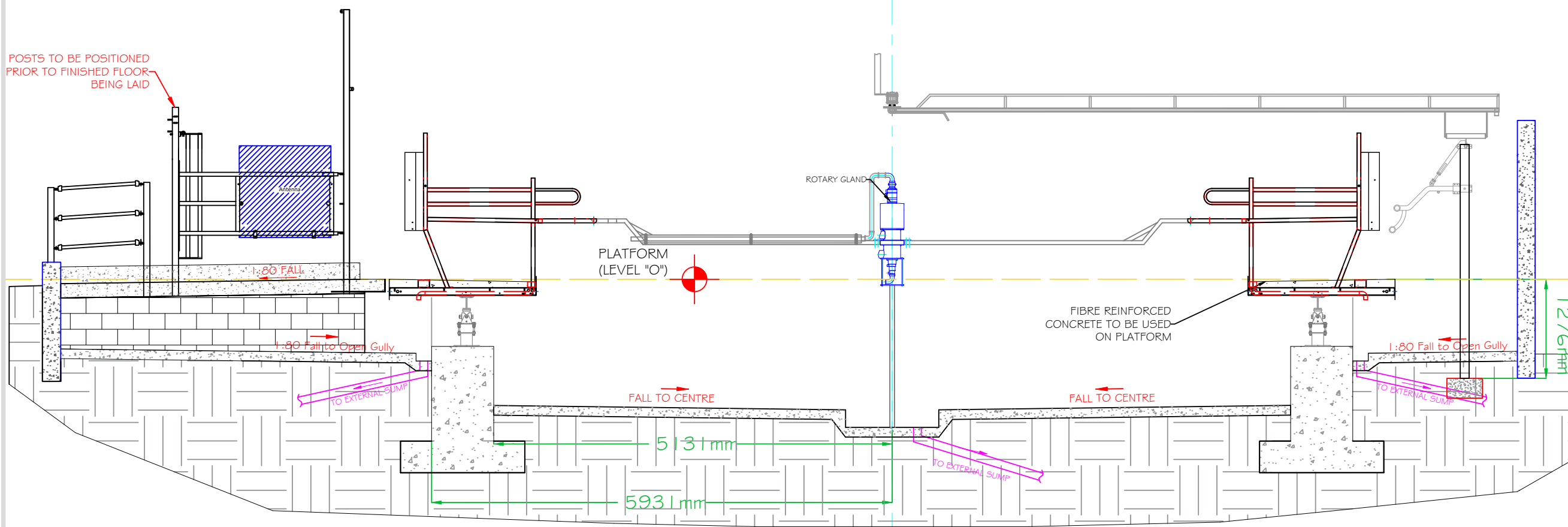

**NOTE:** ALL STRUCTURAL DETAILS, INCLUDING FOUNDATION SIZE AND DEPTH MUST BE DETERMINED BY A QUALIFIED ENGINEER

# CROSS SECTION B-B

PRELIMINARY

**IMPORTANT**  
 Compliance with construction regulations applicable to this project is the sole and exclusive responsibility of the client.  
 Compliance with health and safety regulations applicable to this project is the sole and exclusive responsibility of the client.  
 The appointment of a principal designer applicable to this project and in compliance with regulations is the sole and exclusive responsibility of the client.

These plans and constructed facility are subject to various building codes, standards, ordinances and regulations. Compliance with such codes, standards, ordinances and regulations is your sole and exclusive responsibility. Prior to beginning any construction all dimensions and specifications should be examined and approved by a locally registered engineer and architect.

These plans are furnished as one example of a milking system. The system depicted may not be the most efficient or economical for you. DairyMaster makes no representation of or warranties, expressed or implied as to the efficiency of the system depicted in these plans or its appropriateness for use in your dairy business.

It is your responsibility to conduct a safety risk assessment & ensure safe systems of work on this facility both during construction & operation. These drawings may be only used for locating equipment for installation, all structural design, equipotential bonding and other functional requirements shall be the responsibility of the client.

DairyMaster accepts no responsibility for errors and omissions.

**NOTES:**

- Do not scale.
- Drainage and gullies in parlour, wash room and dairy to be positioned and installed by builder.
- Ensure all post are vertical and plum.
- Double check that the post measurements are correct at both the top and cow stand.
- 1.5% Slope = 1 IN 66.67
- 2.5% Slope = 1 IN 40

**NOTE:**

Production of parlour cannot commence until the drawings are confirmed

**DAIRYMASTER**  
 Experience the difference  
[www.dairymaster.com](http://www.dairymaster.com)  
 Tel: +353 66 7131124  
 Email: [design@dairymaster.com](mailto:design@dairymaster.com)

**OHZ Garzyn**  
 Leszczynska 34  
 62-120  
 Garzyn

Country: Poland

Dealer or Sales Rep:  
 DairyMaster BV

Drawing Number: PD00-001022-000.dwg	Rev: R1 Sht No: 4
--	----------------------

Drawn By: Padraig Harty

Sales Order #:

No Units: 40

Parlour Type:

Swiftflo Revolver - Clockwise

# CROSS SECTION C C

- IMPORTANT:**
1. ROTARY TABLE, ENTRY BRIDGE & ALL STALLWORK MUST BE INSTALLED BY DAIRYMASTER BEFORE THE ENTRY BRIDGE FINISHED FLOOR IS LAID.
  2. FIBRE REINFORCED CONCRETE TO BE USED IN PLINTH & ENTRY DECK.

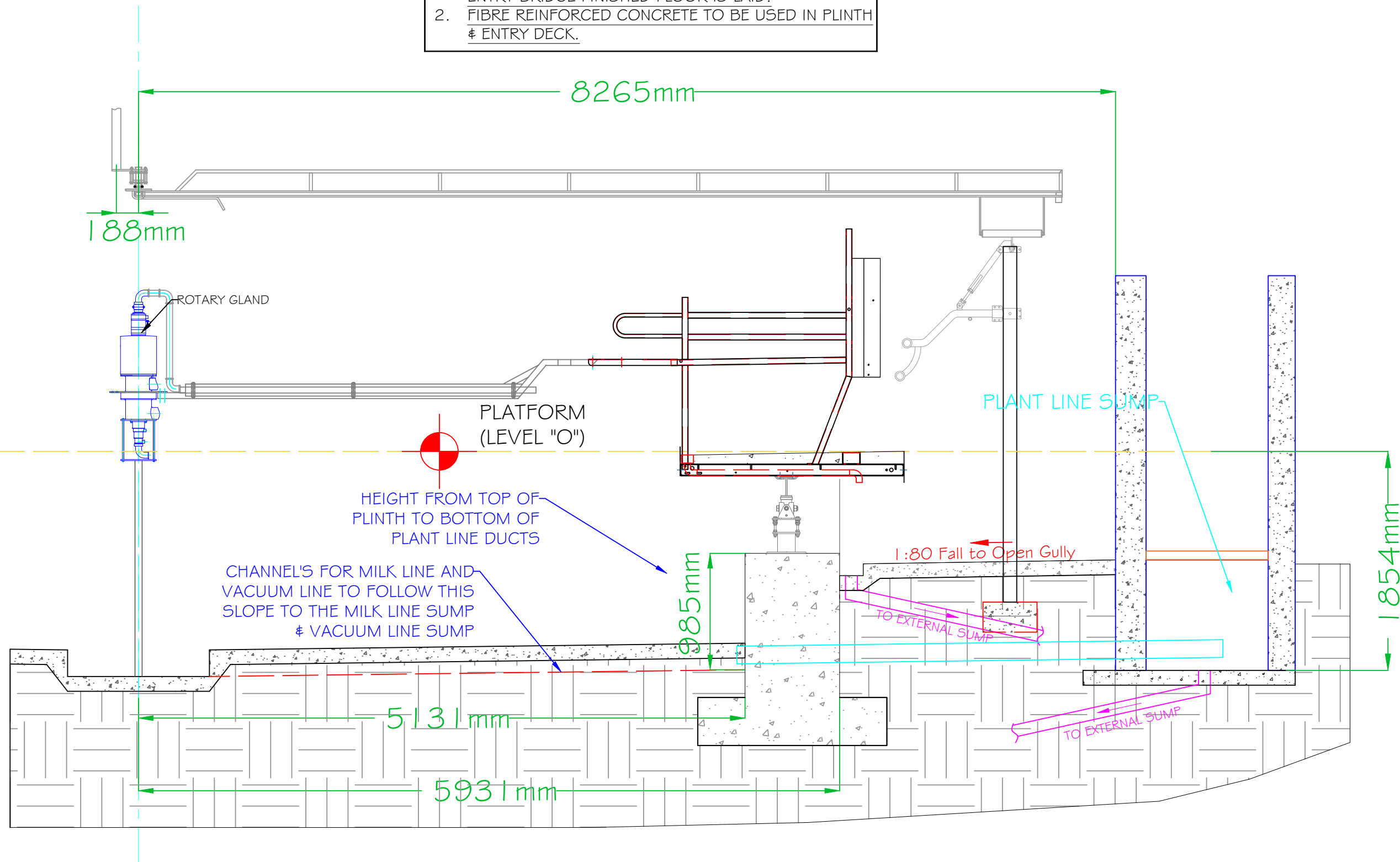

# CROSS SECTION C-C

**NOTE:** ALL STRUCTURAL DETAILS, INCLUDING FOUNDATION SIZE AND DEPTH MUST BE DETERMINED BY A QUALIFIED ENGINEER

PRELIMINARY

**IMPORTANT**  
 Compliance with construction regulations applicable to this project is the sole and exclusive responsibility of the client. Compliance with health and safety regulations applicable to this project is the sole and exclusive responsibility of the client. The appointment of a principal designer applicable to this project and in compliance with regulations is the sole and exclusive responsibility of the client.

These plans and constructed facility are subject to various building codes, standards, ordinances and regulations. Compliance with such codes, standards, ordinances and regulations is your sole and exclusive responsibility. Prior to beginning any construction all dimensions and specifications should be examined and approved by a locally registered engineer and architect.

These plans are furnished as one example of a milking system. The system depicted may not be the most efficient or economical for you. Dairymaster makes no representation of or warranties, expressed or implied as to the efficiency of the system depicted in these plans or its appropriateness for use in your dairy business.

It is your responsibility to conduct a safety risk assessment & ensure safe systems of work on this facility both during construction & operation. These drawings may be only used for locating equipment for installation, all structural design, equipotential bonding and other functional requirements shall be the responsibility of the client.

Dairymaster accepts no responsibility for errors and omissions.

**NOTES:**

- Do not scale.
- Drainage and gullies in parlour, wash room and dairy to be positioned and installed by builder.
- Ensure all post are vertical and plum.
- Double check that the post measurements are correct at both the top and cow stand.
- 1.5% Slope = 1 IN 66.67
- 2.5% Slope = 1 IN 40

**NOTE:**

Production of parlour cannot commence until the drawings are confirmed

**DAIRYMASTER**  
 Experience the difference  
[www.dairymaster.com](http://www.dairymaster.com)  
 Tel: +353 66 7131124  
 Email: [design@dairymaster.com](mailto:design@dairymaster.com)

**OHZ Garzyn**  
 Leszczynska 34  
 62-120  
 Garzyn

Country: Poland

Dealer or Sales Rep:  
 Dairymaster BV

Drawing Number: PD00-001022-000.dwg	Rev: R1 Sht No: 5
--	----------------------

Drawn By: Pdraig Harty

Sales Order #:

No Units: 40

Parlour Type:

Swiftflo Revolver - Clockwise

# CONCRETE LEVELS

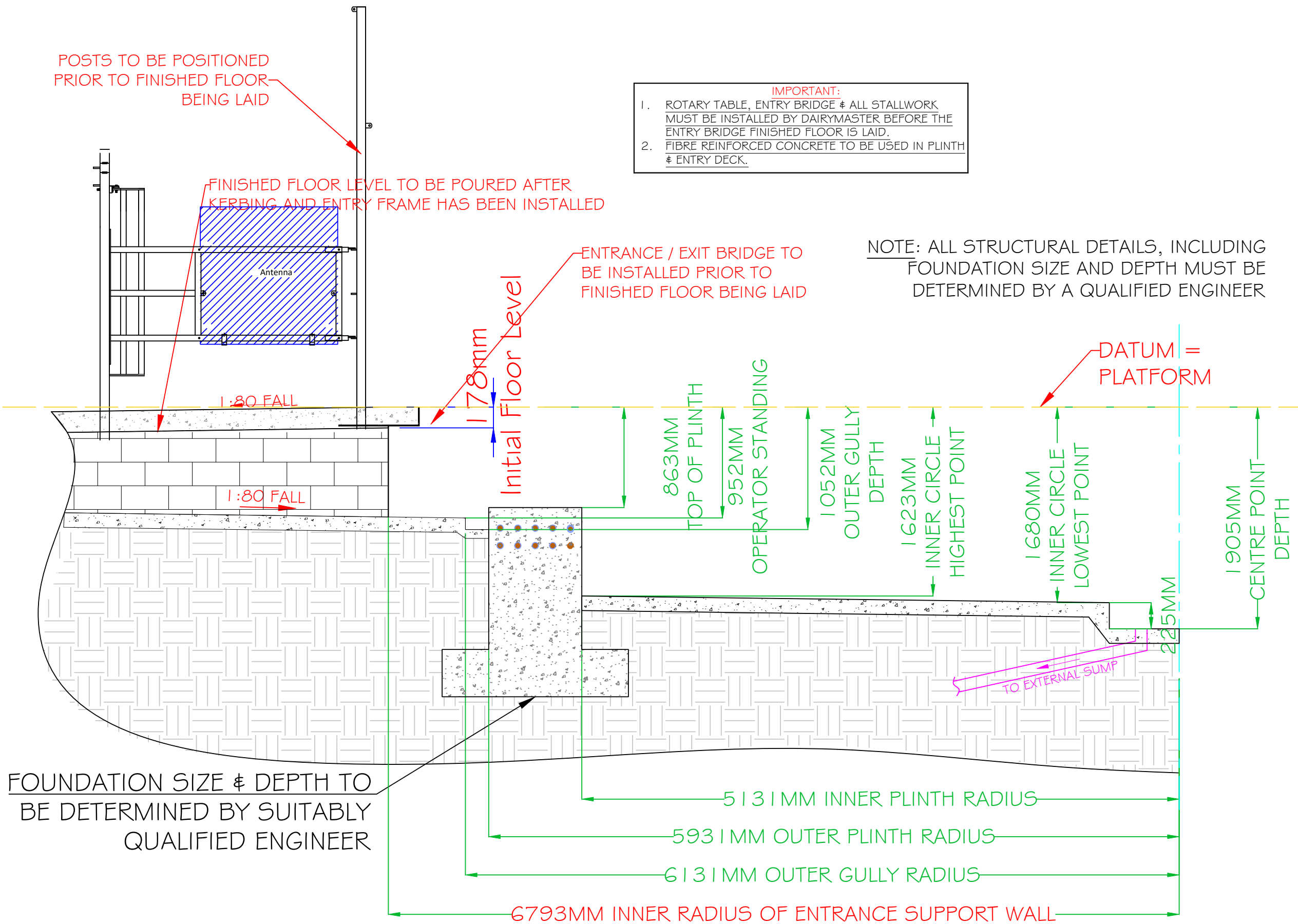

**IMPORTANT:**

1. ROTARY TABLE, ENTRY BRIDGE & ALL STALLWORK MUST BE INSTALLED BY DAIRYMASTER BEFORE THE ENTRY BRIDGE FINISHED FLOOR IS LAID.
2. FIBRE REINFORCED CONCRETE TO BE USED IN PLINTH & ENTRY DECK.

**NOTE:** ALL STRUCTURAL DETAILS, INCLUDING FOUNDATION SIZE AND DEPTH MUST BE DETERMINED BY A QUALIFIED ENGINEER

**IMPORTANT**  
 Compliance with construction regulations applicable to this project is the sole and exclusive responsibility of the client. Compliance with health and safety regulations applicable to this project is the sole and exclusive responsibility of the client. The appointment of a principal designer applicable to this project and in compliance with regulations is the sole and exclusive responsibility of the client.

These plans and constructed facility are subject to various building codes, standards, ordinances and regulations. Compliance with such codes, standards, ordinances and regulations is your sole and exclusive responsibility. Prior to beginning any construction all dimensions and specifications should be examined and approved by a locally registered engineer and architect.

These plans are furnished as one example of a milking system. The system depicted may not be the most efficient or economical for you. Dairymaster makes no representation of or warranties, expressed or implied as to the efficiency of the system depicted in these plans or its appropriateness for use in your dairy business.

It is your responsibility to conduct a safety risk assessment & ensure safe systems of work on this facility both during construction & operation. These drawings may be only used for locating equipment for installation, all structural design, equipotential bonding and other functional requirements shall be the responsibility of the client.

Dairymaster accepts no responsibility for errors and omissions.

- NOTES:**
- Do not scale.
  - Drainage and gullies in parlour, wash room and dairy to be positioned and installed by builder.
  - Ensure all post are vertical and plum.
  - Double check that the post measurements are correct at both the top and cow stand.
  - 1.5% Slope = 1 IN 66.67
  - 2.5% Slope = 1 IN 40

**NOTE:**  
 Production of parlour cannot commence until the drawings are confirmed



Experience the difference  
[www.dairymaster.com](http://www.dairymaster.com)  
 Tel: +353 66 7131124  
 Email: [design@dairymaster.com](mailto:design@dairymaster.com)

**OHZ Garzyn**  
 Leszczynska 34  
 62-120  
 Garzyn

Country: Poland  
 Dealer or Sales Rep:  
 Dairymaster BV

Drawing Number: PD00-001022-000.dwg	Rev: R1 Sht No: 6
--	----------------------

Drawn By: Padraig Harty

Sales Order #:

No Units: 40

Parlour Type:  
 Swiftflo Revolver - Clockwise

# CONCRETE LEVELS

PRELIMINARY



# ELECTRICAL DUCTING LAYOUT

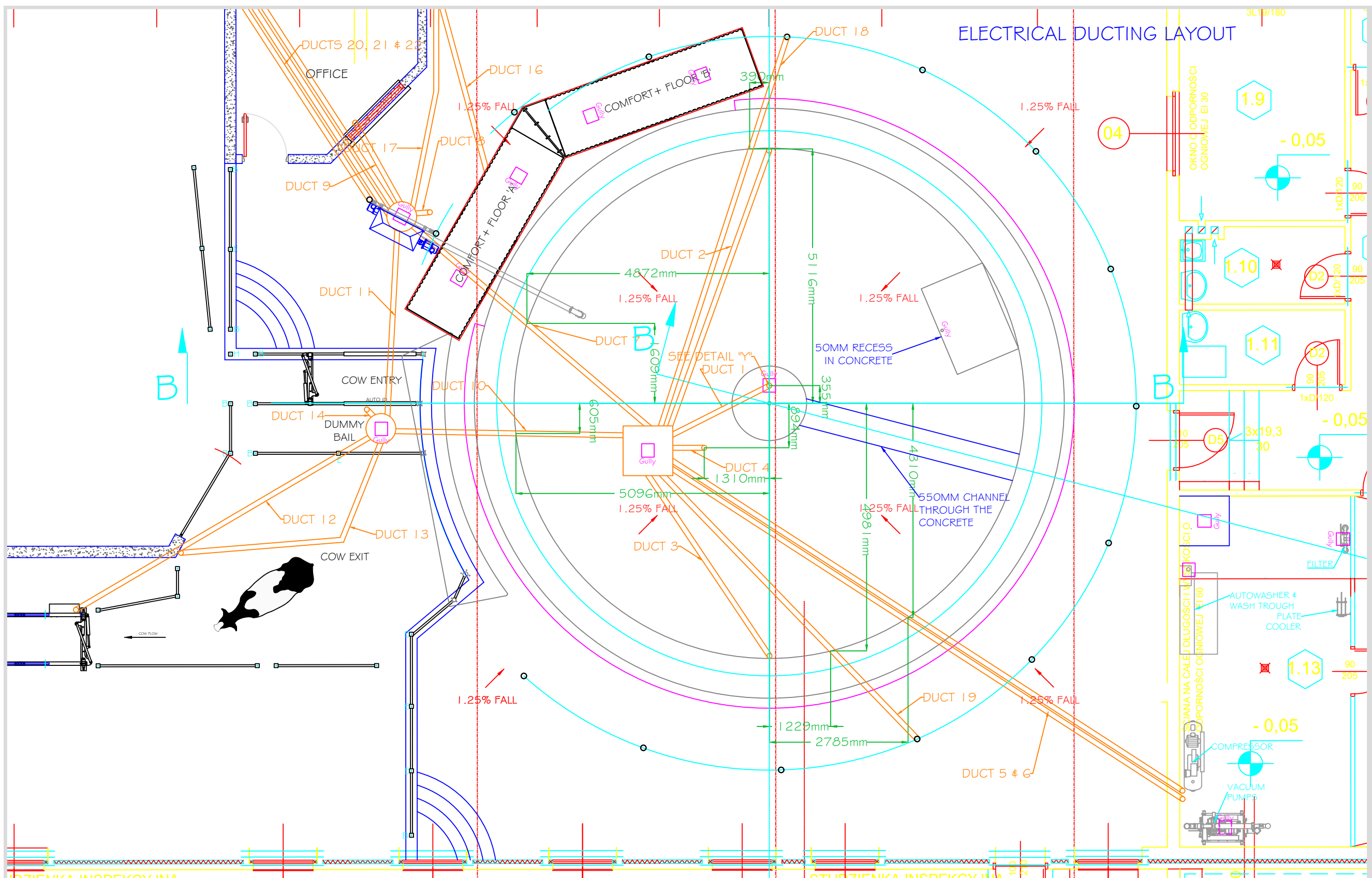

**IMPORTANT**  
 Compliance with construction regulations applicable to this project is the sole and exclusive responsibility of the client. Compliance with health and safety regulations applicable to this project is the sole and exclusive responsibility of the client. The appointment of a principal designer applicable to this project and in compliance with regulations is the sole and exclusive responsibility of the client.

These plans and constructed facility are subject to various building codes, standards, ordinances and regulations. Compliance with such codes, standards, ordinances and regulations is your sole and exclusive responsibility. Prior to beginning any construction all dimensions and specifications should be examined and approved by a locally registered engineer and architect.

These plans are furnished as one example of a milking system. The system depicted may not be the most efficient or economical for you. DairyMaster makes no representation of or warranties, expressed or implied as to the efficiency of the system depicted in these plans or its appropriateness for use in your dairy business.

It is your responsibility to conduct a safety risk assessment & ensure safe systems of work on this facility both during construction & operation. These drawings may be only used for locating equipment for installation, all structural design, equipotential bonding and other functional requirements shall be the responsibility of the client.

DairyMaster accepts no responsibility for errors and omissions.

- NOTES:**
- Do not scale.
  - Drainage and gullies in parlour, wash room and dairy to be positioned and installed by builder.
  - Ensure all post are vertical and plum.
  - Double check that the post measurements are correct at both the top and cow stand.
  - 1.5% Slope = 1 IN 66.67
  - 2.5% Slope = 1 IN 40

**NOTE:**  
 Production of parlour cannot commence until the drawings are confirmed

Experience the difference  
[www.dairymaster.com](http://www.dairymaster.com)  
 Tel: +353 66 7131124  
 Email: [design@dairymaster.com](mailto:design@dairymaster.com)

**OHZ Garzyn**  
 Leszczynska 34  
 62-120  
 Garzyn

Country: Poland

Dealer or Sales Rep:  
 DairyMaster BV

Drawing Number: PD00-001022-000.dwg  
 Rev: R1  
 Sht No: 7

Drawn By: Padraig Harty

Sales Order #:

No Units: 40

Parlour Type:  
 Swiftflo Revolver - Clockwise

## DUCTING DETAILS

- DUCT 1 - FROM CENTRAL DUCT TO GLAND
- DUCT 2 - FROM CENTRAL DUCT TO DRIVE WHEEL 1
- DUCT 3 - FROM CENTRAL DUCT TO DRIVE WHEEL 2
- DUCT 4 - FROM CENTRAL DUCT TO MONITOR LOCATION
- DUCT 5 - FROM CENTRAL DUCT TO POWER HOUSE
- DUCT 6 - FROM CENTRAL DUCT TO POWER HOUSE
- DUCT 7 - FROM CENTRAL DUCT TO JUNCTION BOX AT OPERATOR LOCATION
- DUCT 8 - FROM JUNCTION BOX AT OPERATOR LOCATION TO OPERATOR CONSOLE (SEE DETAIL Z')
- DUCT 9 - FROM JUNCTION BOX AT OPERATOR LOCATION TO OFFICE
- DUCT 10 - FROM CENTRAL DUCT TO DUMMY BAIL ON BRIDGE
- DUCT 11 - FROM DUMMY BAIL ON BRIDGE TO JUNCTION BOX AT OPERATOR LOCATION
- DUCT 12 - DUMMY BAIL ON BRIDGE TO DRAFTING
- DUCT 13 - DUMMY BAIL ON BRIDGE TO BACKING GATE
- DUCT 14 - DUMMY BAIL ON BRIDGE TO AUTO ID
- DUCT 15 - CHEMICAL DUCT FROM CHEMICAL STORE TO FRONT OF MILK TANK
- DUCT 16 - FROM COMFORT + FLOOR POWER UNIT TO JUNCTION BOX AT OPERATOR (SIGNAL)
- DUCT 17 - FROM COMFORT + FLOOR POWER UNIT TO COMFORT FLOOR (HOISING)
- DUCT 18 - FROM CENTRAL DUCT TO RUMP RAIL POST
- DUCT 19 - FROM CENTRAL DUCT TO RUMP RAIL POST
- DUCT 20 - FROM JUNCTION BOX AT OPERATOR LOCATION TO OFFICE
- DUCT 21 - FROM JUNCTION BOX AT OPERATOR LOCATION TO OFFICE
- DUCT 22 - BACK FEEDER POST TO OFFICE

- DUCT 12 - DUMMY BAIL ON BRIDGE TO DRAFTING
- DUCT 13 - DUMMY BAIL ON BRIDGE TO BACKING GATE
- DUCT 14 - DUMMY BAIL ON BRIDGE TO AUTO ID
- DUCT 15 - CHEMICAL DUCT FROM CHEMICAL STORE TO FRONT OF MILK TANK
- DUCT 16 - FROM COMFORT + FLOOR POWER UNIT TO JUNCTION BOX AT OPERATOR (SIGNAL)
- DUCT 17 - FROM COMFORT + FLOOR POWER UNIT TO COMFORT FLOOR (HOISING)
- DUCT 18 - FROM CENTRAL DUCT TO RUMP RAIL POST
- DUCT 19 - FROM CENTRAL DUCT TO RUMP RAIL POST
- DUCT 20 - FROM JUNCTION BOX AT OPERATOR LOCATION TO OFFICE
- DUCT 21 - FROM JUNCTION BOX AT OPERATOR LOCATION TO OFFICE
- DUCT 22 - BACK FEEDER POST TO OFFICE

**USE LONG RADIUS BENDS ON ALL DUCTS**

## DUCTING NOTES

- 1) THE POSITIONS OF THE CONDUITS AND DUCTS ARE SHOWN AS A GUIDE ONLY, AND THE EXACT POSITION OF THE DUCTING SHOULD BE DETERMINED ON SITE, ALLOWING FOR ANY CHANGES IN FLOOR LEVELS.
- 2) ALL DUCTS SHOWN ARE FOR THE INSTALLATION OF DAIRYMASTER EQUIPMENT ONLY AND EXTRA DUCTS REQUIRED BY ELECTRICIANS AND PLUMBERS MAY NEED TO BE ADDED
- 3) LEAVE FISH WIRE/DRAW ROPE IN ALL DUCTS
- 4) 100MM SMOOTH BORE DUCTING TO BE USED (UNLESS STATED OTHERWISE).
- 5) ALL DUCTING TO BE UNDERGROUND.
- 6) ALL DUCTING TO BE SUPPLIED BY CLIENT.
- 7) ALL DUCTS TO BE 4" UNLESS OTHERWISE STATED
- 8) ALL DUCTS TO BE FINISHED TO DETAIL Y" EXCEPT DUCT 9.

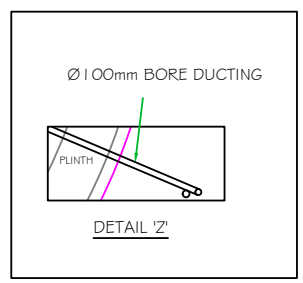
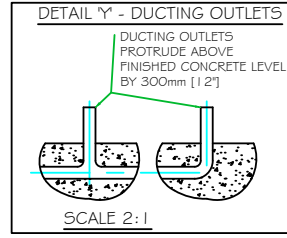
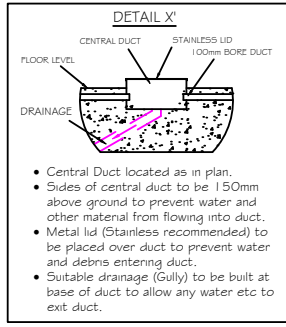

PRELIMINARY

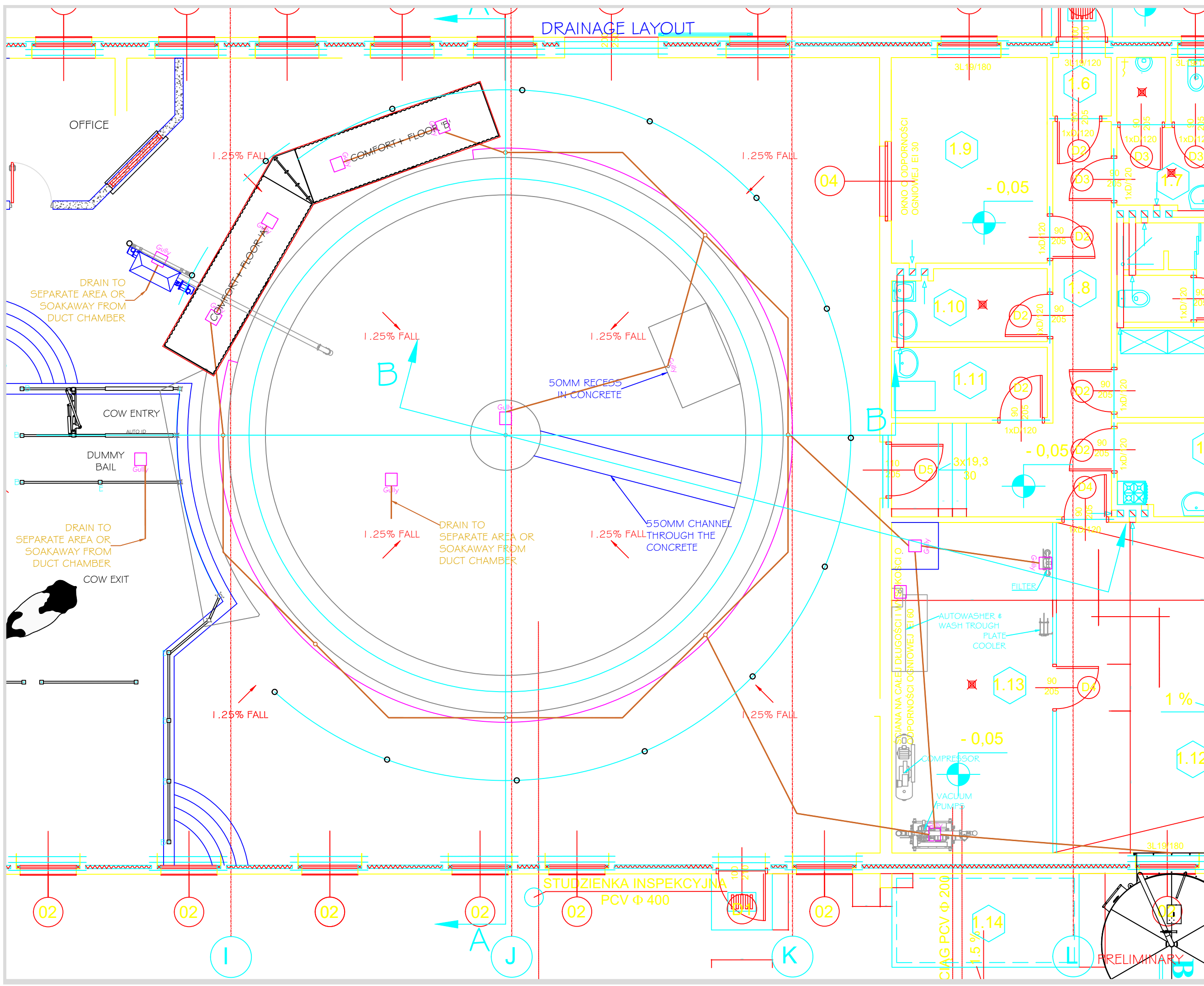

**IMPORTANT**  
 Compliance with construction regulations applicable to this project is the sole and exclusive responsibility of the client. Compliance with health and safety regulations applicable to this project is the sole and exclusive responsibility of the client. The appointment of a principal designer applicable to this project and in compliance with regulations is the sole and exclusive responsibility of the client.

These plans and constructed facility are subject to various building codes, standards, ordinances and regulations. Compliance with such codes, standards, ordinances and regulations is your sole and exclusive responsibility. Prior to beginning any construction all dimensions and specifications should be examined and approved by a locally registered engineer and architect.

These plans are furnished as one example of a milking system. The system depicted may not be the most efficient or economical for you. DairyMaster makes no representation of or warranties, expressed or implied as to the efficiency of the system depicted in these plans or its appropriateness for use in your dairy business.

It is your responsibility to conduct a safety risk assessment & ensure safe systems of work on this facility both during construction & operation. These drawings may be only used for locating equipment for installation, all structural design, equipotential bonding and other functional requirements shall be the responsibility of the client.

DairyMaster accepts no responsibility for errors and omissions.

- NOTES:**
- Do not scale.
  - Drainage and gullies in parlour, wash room and dairy to be positioned and installed by builder.
  - Ensure all post are vertical and plum.
  - Double check that the post measurements are correct at both the top and cow stand.
  - 1.5% Slope = 1 IN 66.67
  - 2.5% Slope = 1 IN 40

**NOTE:**  
 Production of parlour cannot commence until the drawings are confirmed

**DAIRYMASTER**  
  
 Experience the difference  
[www.dairymaster.com](http://www.dairymaster.com)  
 Tel: +353 66 7131124  
 Email: [design@dairymaster.com](mailto:design@dairymaster.com)

**OHZ Garzyn**  
 Leszczynska 34  
 62-120  
 Garzyn

Country: Poland  
 Dealer or Sales Rep:  
 DairyMaster BV

Drawing Number: PD00-001022-000.dwg  
 Rev: R1  
 Sht No: 8

Drawn By: Padraig Harty

Sales Order #:

No Units: 40

Parlour Type:  
 Swiftflo Revolver - Clockwise



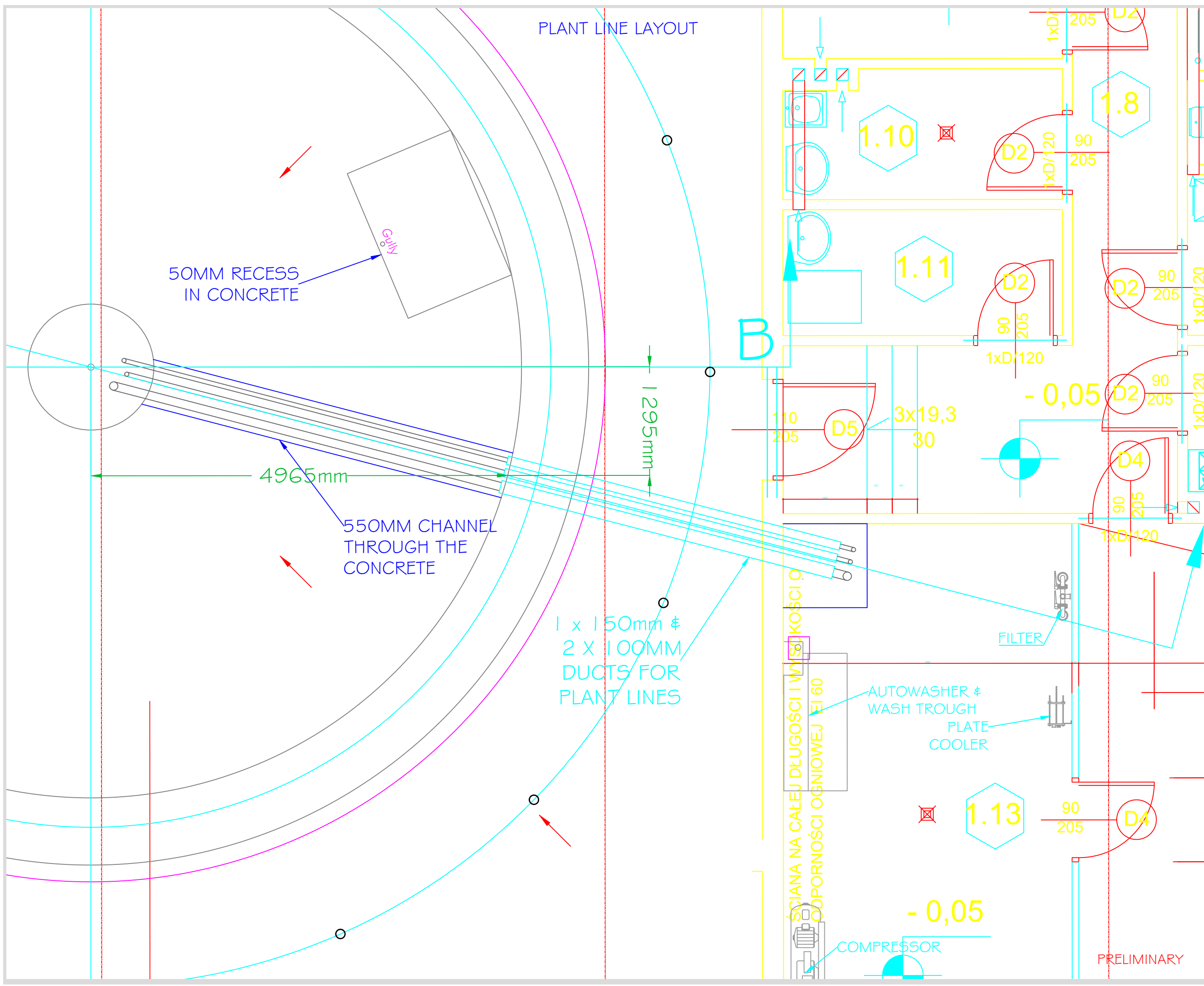

**IMPORTANT**  
 Compliance with construction regulations applicable to this project is the sole and exclusive responsibility of the client. Compliance with health and safety regulations applicable to this project is the sole and exclusive responsibility of the client. The appointment of a principal designer applicable to this project and in compliance with regulations is the sole and exclusive responsibility of the client.

These plans and constructed facility are subject to various building codes, standards, ordinances and regulations. Compliance with such codes, standards, ordinances and regulations is your sole and exclusive responsibility. Prior to beginning any construction all dimensions and specifications should be examined and approved by a locally registered engineer and architect.

These plans are furnished as one example of a milking system. The system depicted may not be the most efficient or economical for you. Dairymaster makes no representation of or warranties, expressed or implied as to the efficiency of the system depicted in these plans or its appropriateness for use in your dairy business.

It is your responsibility to conduct a safety risk assessment & ensure safe systems of work on this facility both during construction & operation. These drawings may be only used for locating equipment for installation, all structural design, equipotential bonding and other functional requirements shall be the responsibility of the client.

Dairymaster accepts no responsibility for errors and omissions.

- NOTES:**
- Do not scale.
  - Drainage and gullies in parlour, wash room and dairy to be positioned and installed by builder.
  - Ensure all post are vertical and plum.
  - Double check that the post measurements are correct at both the top and cow stand.
  - 1.5% Slope = 1 IN 66.67
  - 2.5% Slope = 1 IN 40

**NOTE:**  
 Production of parlour cannot commence until the drawings are confirmed

**DAIRYMASTER**  
  
 Experience the difference  
[www.dairymaster.com](http://www.dairymaster.com)  
 Tel: +353 66 7131124  
 Email: [design@dairymaster.com](mailto:design@dairymaster.com)

**OHZ Garzyn**  
 Leszczynska 34  
 62-120  
 Garzyn

Country: Poland  
 Dealer or Sales Rep:  
 Dairymaster BV

Drawing Number: PD00-001022-000.dwg	Rev: R1 Sht No: 9
--	----------------------

Drawn By: Padraig Harty

Sales Order #:

No Units: 40

Parlour Type:  
 Swiftflo Revolver - Clockwise

PRELIMINARY

COMFORT + FLOOR SET OUT

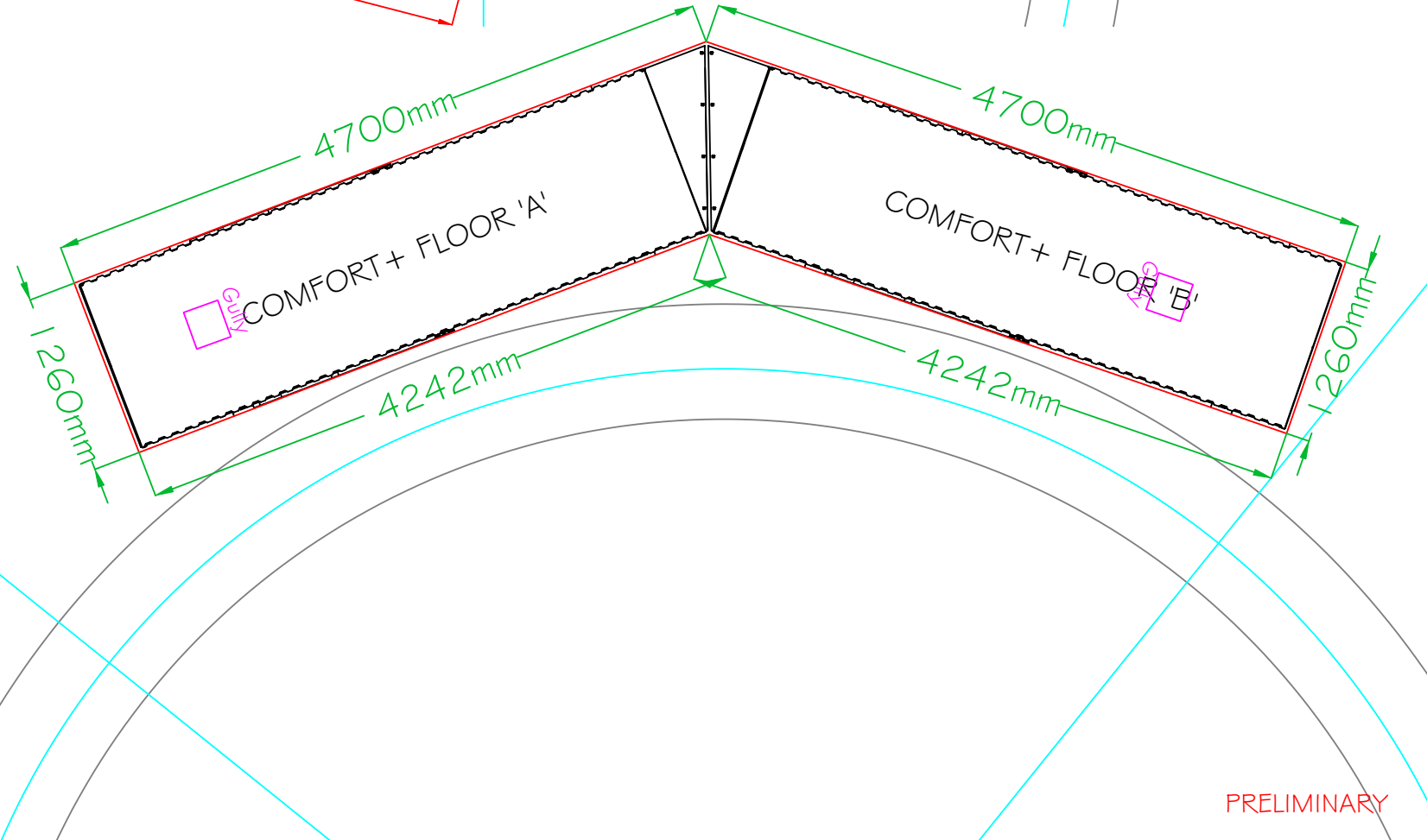
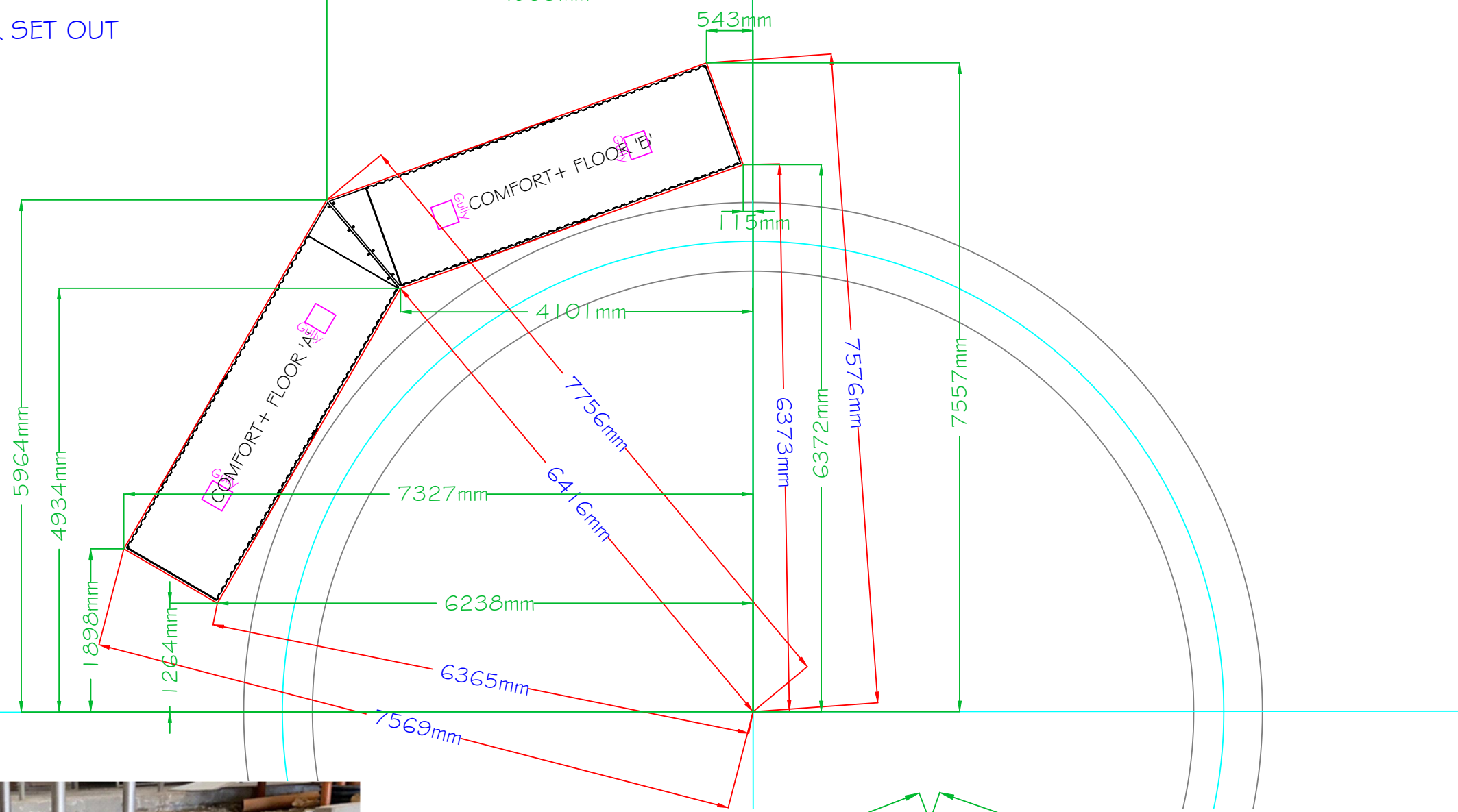

PRELIMINARY

**IMPORTANT**  
 Compliance with construction regulations applicable to this project is the sole and exclusive responsibility of the client.  
 Compliance with health and safety regulations applicable to this project is the sole and exclusive responsibility of the client.  
 The appointment of a principal designer applicable to this project and in compliance with regulations is the sole and exclusive responsibility of the client.

These plans and constructed facility are subject to various building codes, standards, ordinances and regulations. Compliance with such codes, standards, ordinances and regulations is your sole and exclusive responsibility. Prior to beginning any construction all dimensions and specifications should be examined and approved by a locally registered engineer and architect.

These plans are furnished as one example of a milking system. The system depicted may not be the most efficient or economical for you. Dairymaster makes no representation of or warranties, expressed or implied as to the efficiency of the system depicted in these plans or its appropriateness for use in your dairy business.

It is your responsibility to conduct a safety risk assessment & ensure safe systems of work on this facility both during construction & operation. These drawings may be only used for locating equipment for installation, all structural design, equipotential bonding and other functional requirements shall be the responsibility of the client.

Dairymaster accepts no responsibility for errors and omissions.

- NOTES:**
- Do not scale.
  - Drainage and gullies in parlour, wash room and dairy to be positioned and installed by builder.
  - Ensure all post are vertical and plum.
  - Double check that the post measurements are correct at both the top and cow stand.
  - 1.5% Slope = 1 IN 66.67
  - 2.5% Slope = 1 IN 40

**NOTE:**  
 Production of parlour cannot commence until the drawings are confirmed

**DAIRYMASTER**  
  
 Experience the difference  
[www.dairymaster.com](http://www.dairymaster.com)  
 Tel: +353 66 7131124  
 Email: [design@dairymaster.com](mailto:design@dairymaster.com)

**OHZ Garzyn**  
 Leszczynska 34  
 62-120  
 Garzyn

Country: Poland

Dealer or Sales Rep:  
 Dairymaster BV

Drawing Number: PD00-001022-000.dwg	Rev: R1 Sht No: 10
--	-----------------------

Drawn By: Padraig Harty

Sales Order #:

No Units: 40

Parlour Type:  
 Swiftflo Revolver - Clockwise

# COMFORT + FLOOR CROSS SECTION

COMFORT + FLOOR IS DELIVERED ASSEMBLED THE FLOOR TANK NEEDS TO BE BUILT ACCORDING TO THE COMFORT + FLOOR SET OUT DRAWING

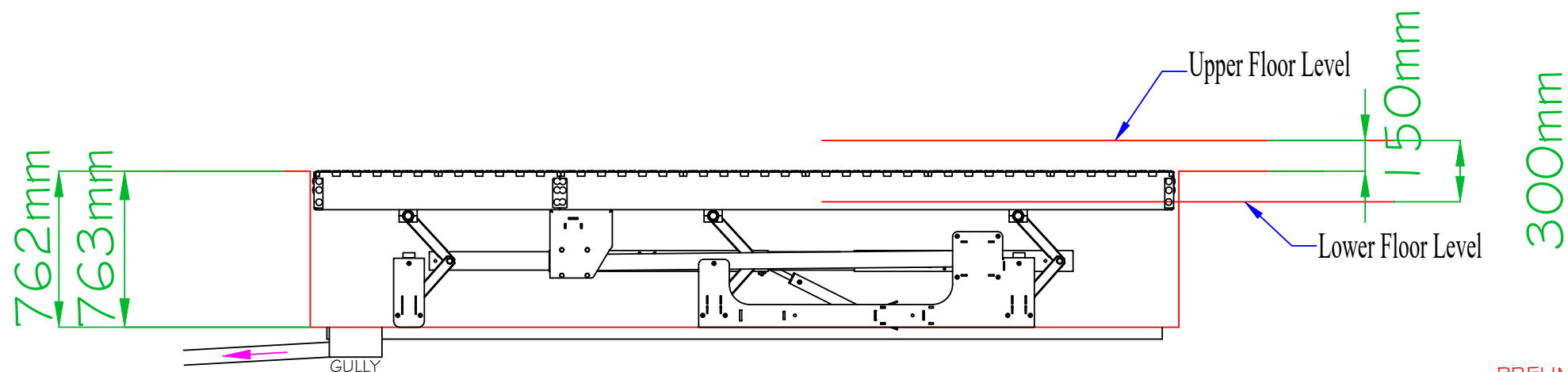
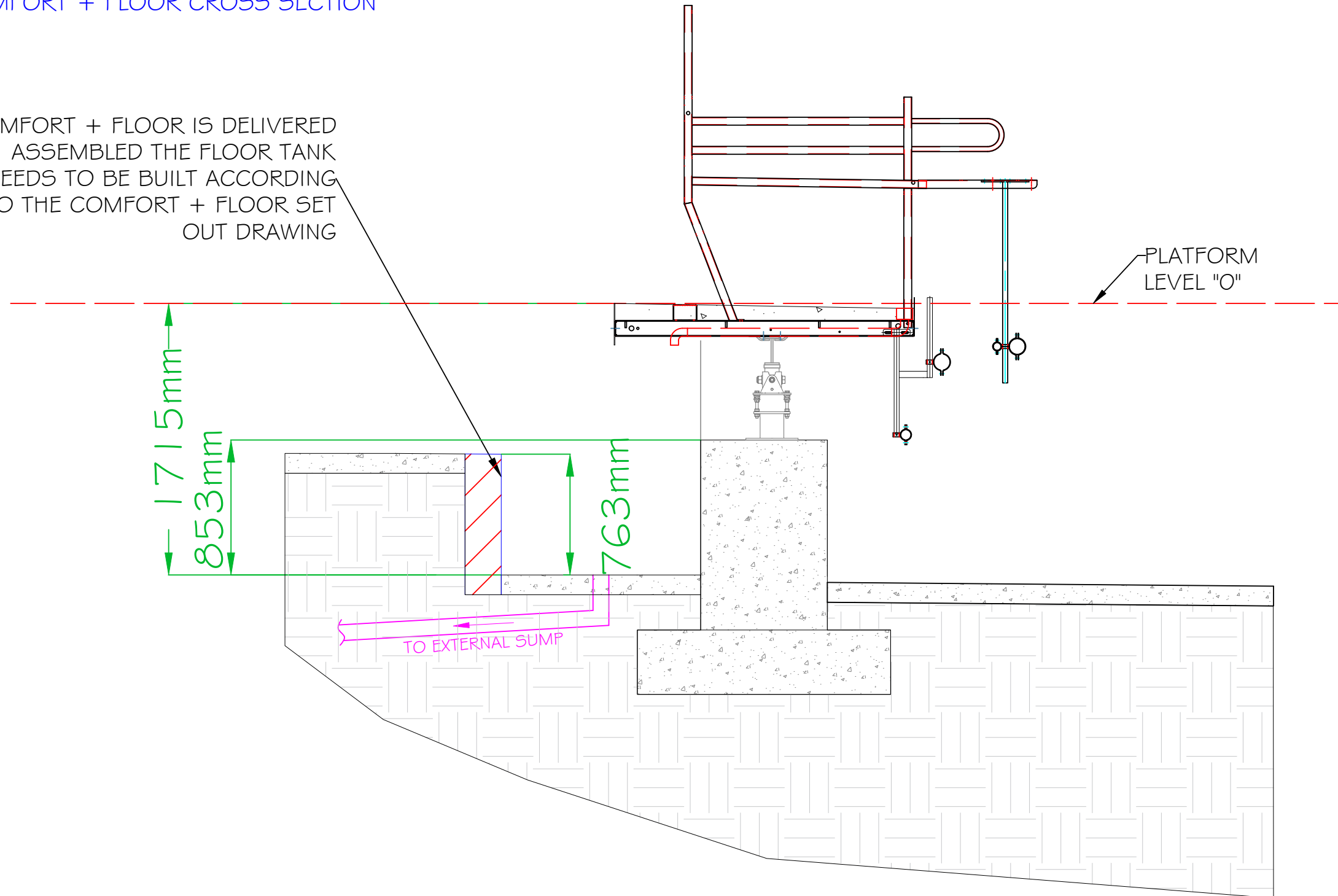

PRELIMINARY

**IMPORTANT**  
 Compliance with construction regulations applicable to this project is the sole and exclusive responsibility of the client.  
 Compliance with health and safety regulations applicable to this project is the sole and exclusive responsibility of the client.  
 The appointment of a principal designer applicable to this project and in compliance with regulations is the sole and exclusive responsibility of the client.

These plans and constructed facility are subject to various building codes, standards, ordinances and regulations. Compliance with such codes, standards, ordinances and regulations is your sole and exclusive responsibility. Prior to beginning any construction all dimensions and specifications should be examined and approved by a locally registered engineer and architect.

These plans are furnished as one example of a milking system. The system depicted may not be the most efficient or economical for you. Dairymaster makes no representation of or warranties, expressed or implied as to the efficiency of the system depicted in these plans or its appropriateness for use in your dairy business.

It is your responsibility to conduct a safety risk assessment & ensure safe systems of work on this facility both during construction & operation. These drawings may be only used for locating equipment for installation, all structural design, equipotential bonding and other functional requirements shall be the responsibility of the client.

Dairymaster accepts no responsibility for errors and omissions.

**NOTES:**

- Do not scale.
- Drainage and gullies in parlour, wash room and dairy to be positioned and installed by builder.
- Ensure all post are vertical and plum.
- Double check that the post measurements are correct at both the top and cow stand.
- 1.5% Slope = 1 IN 66.67
- 2.5% Slope = 1 IN 40

**NOTE:**

Production of parlour cannot commence until the drawings are confirmed

**DAIRYMASTER**  
 Experience the difference  
[www.dairymaster.com](http://www.dairymaster.com)  
 Tel: +353 66 7131124  
 Email: [design@dairymaster.com](mailto:design@dairymaster.com)

**OHZ Garzyn**  
 Leszczynska 34  
 62-120  
 Garzyn

Country: Poland

Dealer or Sales Rep:  
 Dairymaster BV

Drawing Number: PD00-001022-000.dwg	Rev: R1 Sht No: 11
--	-----------------------

Drawn By: Padraig Harty

Sales Order #:

No Units: 40

Parlour Type:

Swiftflo Revolver - Clockwise



BRIDGE & RECEIVER PARK SET-OUT

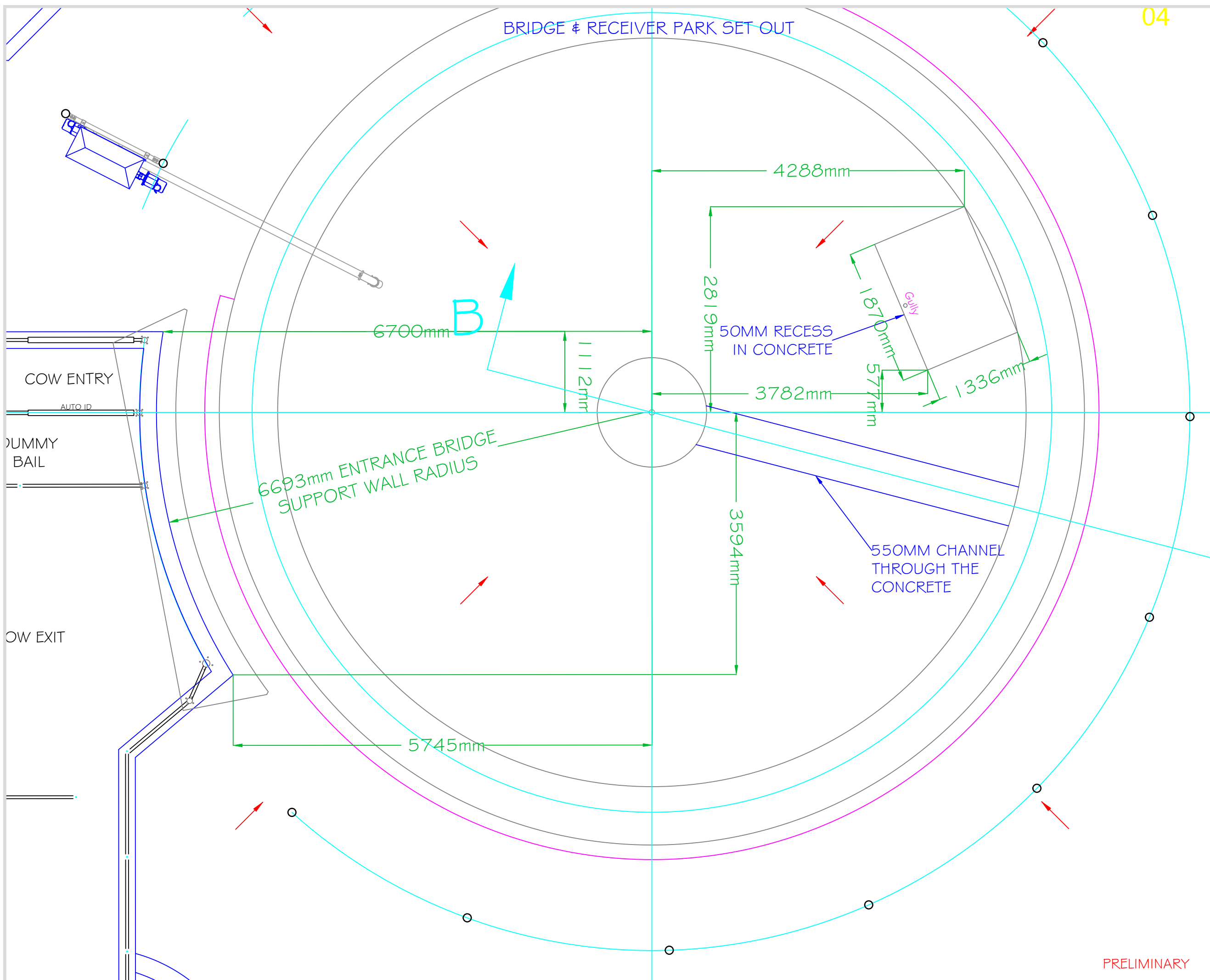

**IMPORTANT**  
 Compliance with construction regulations applicable to this project is the sole and exclusive responsibility of the client. Compliance with health and safety regulations applicable to this project is the sole and exclusive responsibility of the client. The appointment of a principal designer applicable to this project and in compliance with regulations is the sole and exclusive responsibility of the client.

These plans and constructed facility are subject to various building codes, standards, ordinances and regulations. Compliance with such codes, standards, ordinances and regulations is your sole and exclusive responsibility. Prior to beginning any construction all dimensions and specifications should be examined and approved by a locally registered engineer and architect.

These plans are furnished as one example of a milking system. The system depicted may not be the most efficient or economical for you. Dairymaster makes no representation of or warranties, expressed or implied as to the efficiency of the system depicted in these plans or its appropriateness for use in your dairy business.

It is your responsibility to conduct a safety risk assessment & ensure safe systems of work on this facility both during construction & operation. These drawings may be only used for locating equipment for installation, all structural design, equipotential bonding and other functional requirements shall be the responsibility of the client.

Dairymaster accepts no responsibility for errors and omissions.

- NOTES:**
- Do not scale.
  - Drainage and gullies in parlour, wash room and dairy to be positioned and installed by builder.
  - Ensure all post are vertical and plum.
  - Double check that the post measurements are correct at both the top and cow stand.
  - 1.5% Slope = 1 IN 66.67
  - 2.5% Slope = 1 IN 40

**NOTE:**  
 Production of parlour cannot commence until the drawings are confirmed

**DAIRYMASTER**  
  
 Experience the difference  
[www.dairymaster.com](http://www.dairymaster.com)  
 Tel: +353 66 7131124  
 Email: [design@dairymaster.com](mailto:design@dairymaster.com)

**OHZ Garzyn**  
 Leszczynska 34  
 62-120  
 Garzyn

Country: Poland  
 Dealer or Sales Rep:  
 Dairymaster BV

Drawing Number: PD00-001022-000.dwg	Rev: R1 Sht No: 12
--	-----------------------

Drawn By: Padraig Harty

Sales Order #:  
 No Units: 40

Parlour Type:  
 Swiftflo Revolver - Clockwise

PRELIMINARY

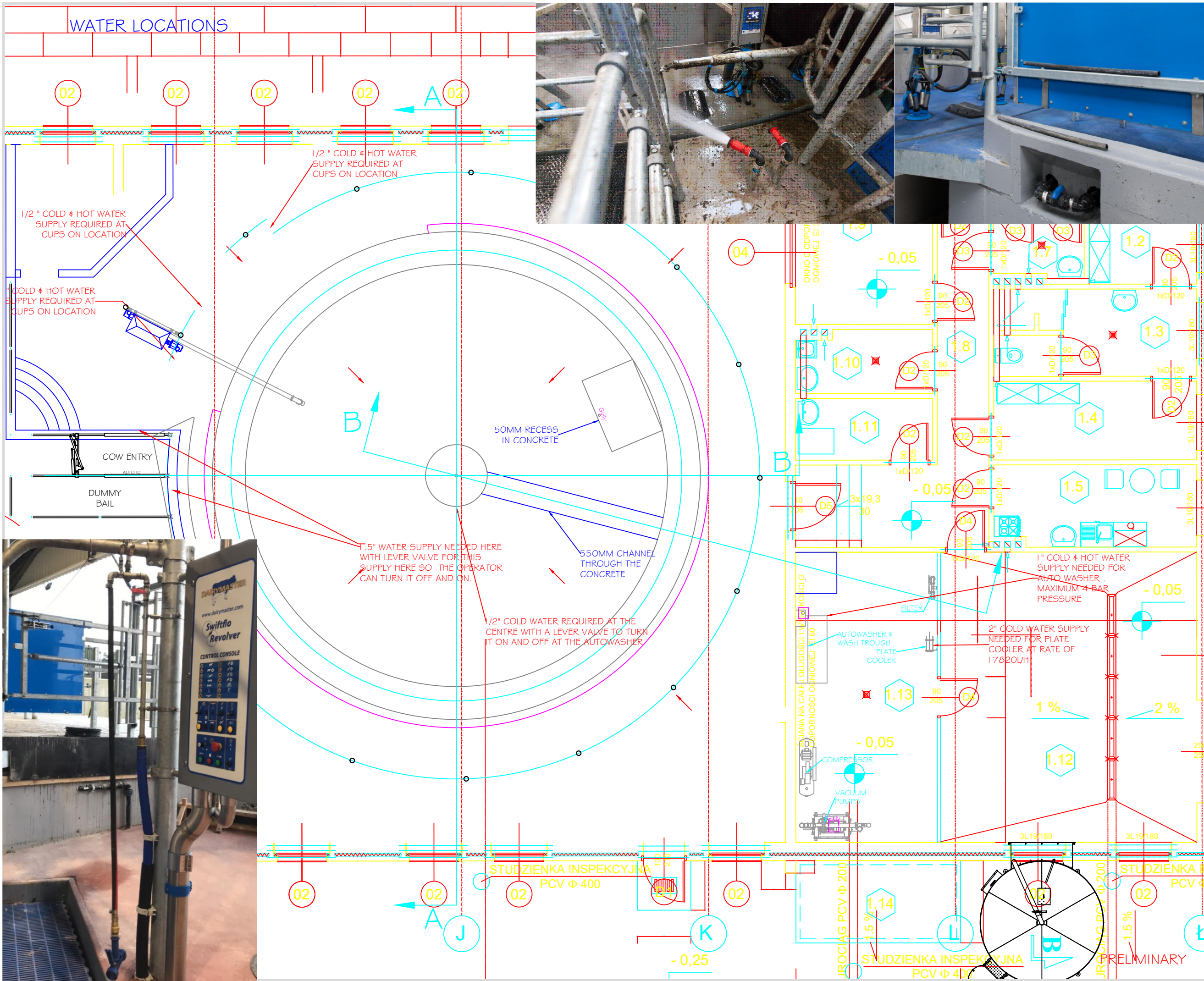

**IMPORTANT**  
 Compliance with construction regulations applicable to this project is the sole and exclusive responsibility of the client. Compliance with health and safety regulations applicable to this project is the sole and exclusive responsibility of the client. The appointment of a principal designer applicable to this project and in compliance with regulations is the sole and exclusive responsibility of the client.

These plans and constructed facility are subject to various building codes, standards, ordinances and regulations. Compliance with such codes, standards, ordinances and regulations is your sole and exclusive responsibility. Prior to beginning any construction all dimensions and specifications should be examined and approved by a locally registered engineer and architect.

These plans are furnished as one example of a milking system. The system depicted may not be the most efficient or economical for you. Dairymaster makes no representation of or warranties, expressed or implied as to the efficiency of the system depicted in these plans or its appropriateness for use in your dairy business.

It is your responsibility to conduct a safety risk assessment & ensure safe systems of work on this facility both during construction & operation. These drawings may be only used for locating equipment for installation, all structural design, equipotential bonding and other functional requirements shall be the responsibility of the client.

Dairymaster accepts no responsibility for errors and omissions.

- NOTES:**
- Do not scale.
  - Drainage and gullies in parlour, wash room and dairy to be positioned and installed by builder.
  - Ensure all post are vertical and plum.
  - Double check that the post measurements are correct at both the top and cow stand.
  - 1.5% Slope = 1 IN 66.67
  - 2.5% Slope = 1 IN 40

**NOTE:**  
 Production of parlour cannot commence until the drawings are confirmed

**DAIRYMASTER**  
 Experience the difference  
[www.dairymaster.com](http://www.dairymaster.com)  
 Tel: +353 66 7131124  
 Email: [design@dairymaster.com](mailto:design@dairymaster.com)

**OHZ Garzyn**  
 Leszczynska 34  
 62-120  
 Garzyn

Country: Poland  
 Dealer or Sales Rep:  
 Dairymaster BV

Drawing Number: PD00-001022-000.dwg  
 Rev: R1  
 Sht No: 13

Drawn By: Padraig Harty

Sales Order #:  
 No Units: 40

Parlour Type:  
 Swiftflo Revolver - Clockwise



# RUMP RAIL SUPPORT POST SET OUT

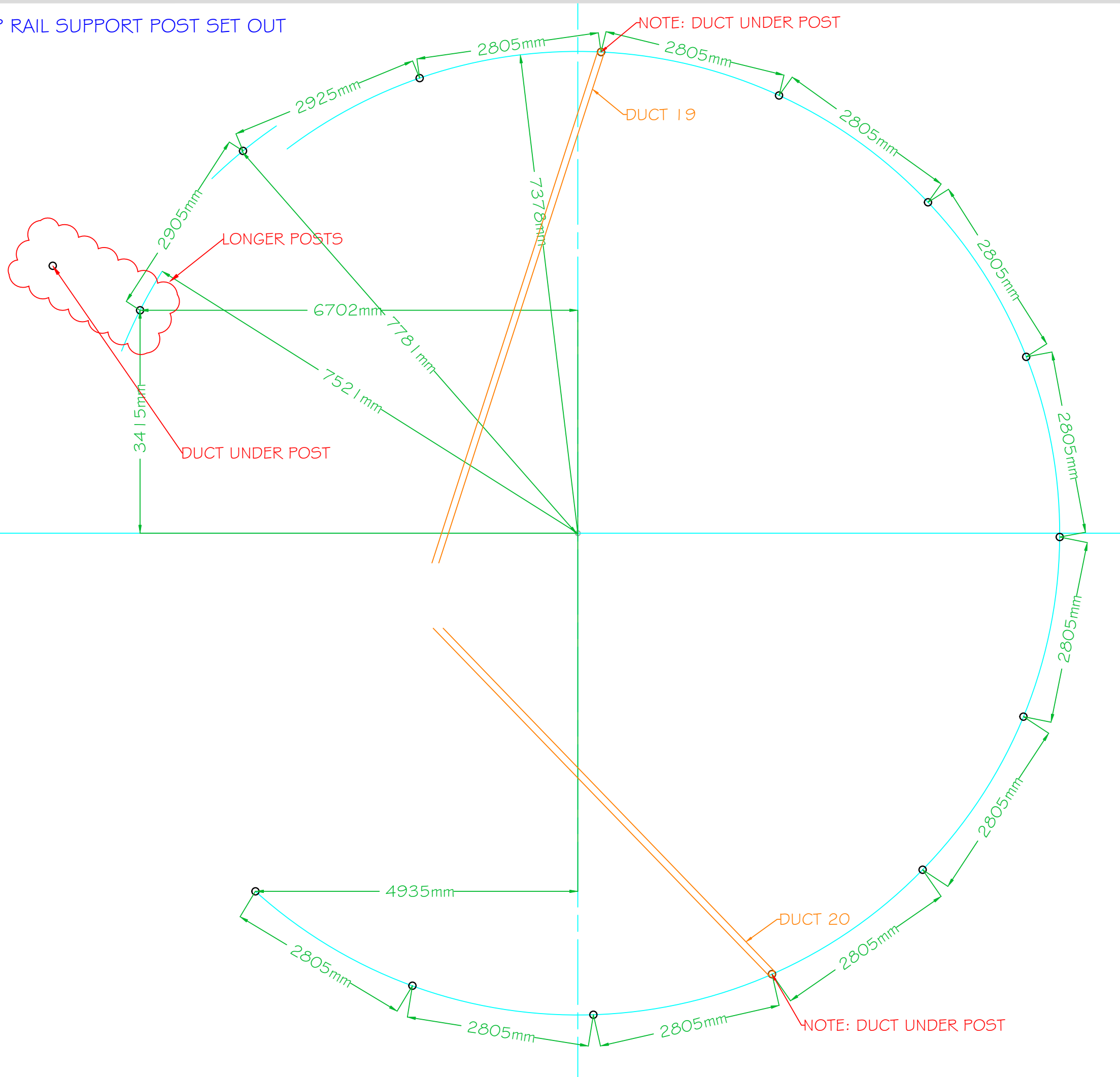

PRELIMINARY

**IMPORTANT**  
 Compliance with construction regulations applicable to this project is the sole and exclusive responsibility of the client. Compliance with health and safety regulations applicable to this project is the sole and exclusive responsibility of the client. The appointment of a principal designer applicable to this project and in compliance with regulations is the sole and exclusive responsibility of the client.

These plans and constructed facility are subject to various building codes, standards, ordinances and regulations. Compliance with such codes, standards, ordinances and regulations is your sole and exclusive responsibility. Prior to beginning any construction all dimensions and specifications should be examined and approved by a locally registered engineer and architect.

These plans are furnished as one example of a milking system. The system depicted may not be the most efficient or economical for you. DairyMaster makes no representation of or warranties, expressed or implied as to the efficiency of the system depicted in these plans or its appropriateness for use in your dairy business.

It is your responsibility to conduct a safety risk assessment & ensure safe systems of work on this facility both during construction & operation. These drawings may be only used for locating equipment for installation, all structural design, equipotential bonding and other functional requirements shall be the responsibility of the client.

DairyMaster accepts no responsibility for errors and omissions.

- NOTES:**
- Do not scale.
  - Drainage and gullies in parlour, wash room and dairy to be positioned and installed by builder.
  - Ensure all post are vertical and plum.
  - Double check that the post measurements are correct at both the top and cow stand.
  - 1.5% Slope = 1 IN 66.67
  - 2.5% Slope = 1 IN 40

**NOTE:**  
 Production of parlour cannot commence until the drawings are confirmed

**DAIRYMASTER**  
 Experience the difference  
[www.dairymaster.com](http://www.dairymaster.com)  
 Tel: +353 66 7131124  
 Email: [design@dairymaster.com](mailto:design@dairymaster.com)

**OHZ Garzyn**  
 Leszczynska 34  
 62-120  
 Garzyn

Country: Poland

Dealer or Sales Rep:  
 DairyMaster BV

Drawing Number: PD00-001022-000.dwg	Rev: R1 Sht No: 14
--	-----------------------

Drawn By: Padraig Harty

Sales Order #:

No Units: 40

Parlour Type:  
 Swiftflo Revolver - Clockwise



# WASH BOOM SUPPORT CROSS SECTION

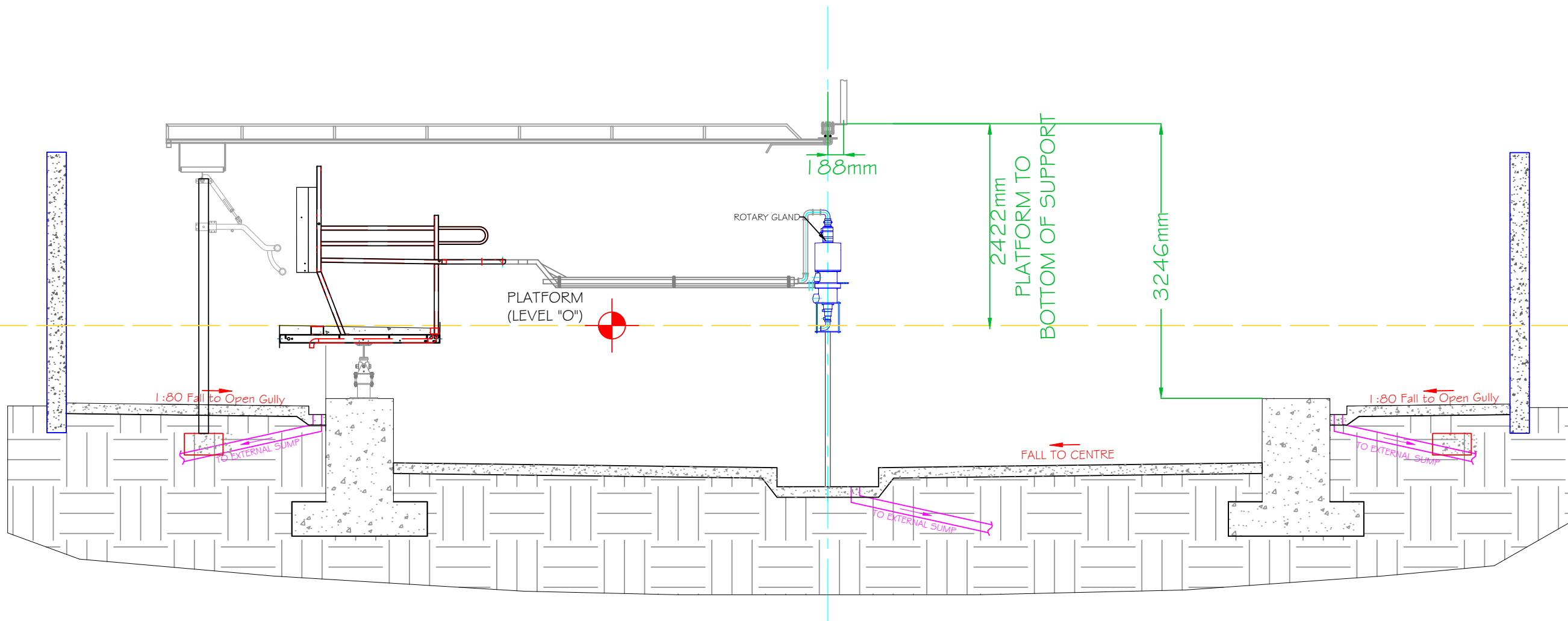

PRELIMINARY

**IMPORTANT**  
 Compliance with construction regulations applicable to this project is the sole and exclusive responsibility of the client.  
 Compliance with health and safety regulations applicable to this project is the sole and exclusive responsibility of the client.  
 The appointment of a principal designer applicable to this project and in compliance with regulations is the sole and exclusive responsibility of the client.

These plans and constructed facility are subject to various building codes, standards, ordinances and regulations. Compliance with such codes, standards, ordinances and regulations is your sole and exclusive responsibility. Prior to beginning any construction all dimensions and specifications should be examined and approved by a locally registered engineer and architect.

These plans are furnished as one example of a milking system. The system depicted may not be the most efficient or economical for you. DairyMaster makes no representation of or warranties, expressed or implied as to the efficiency of the system depicted in these plans or its appropriateness for use in your dairy business.

It is your responsibility to conduct a safety risk assessment & ensure safe systems of work on this facility both during construction & operation. These drawings may be only used for locating equipment for installation, all structural design, equipotential bonding and other functional requirements shall be the responsibility of the client.

DairyMaster accepts no responsibility for errors and omissions.

**NOTES:**

- Do not scale.
- Drainage and gullies in parlour, wash room and dairy to be positioned and installed by builder.
- Ensure all post are vertical and plum.
- Double check that the post measurements are correct at both the top and cow stand.
- 1.5% Slope = 1 IN 66.67
- 2.5% Slope = 1 IN 40

**NOTE:**

Production of parlour cannot commence until the drawings are confirmed

**DAIRYMASTER**  
  
 Experience the difference  
[www.dairymaster.com](http://www.dairymaster.com)  
 Tel: +353 66 7131124  
 Email: [design@dairymaster.com](mailto:design@dairymaster.com)

**OHZ Garzyn**  
 Leszczynska 34  
 62-120  
 Garzyn

Country: Poland

Dealer or Sales Rep:  
 DairyMaster BV

Drawing Number: PD00-001022-000.dwg	Rev: R1 Sht No: 15
--	-----------------------

Drawn By: Pdraig Harty

Sales Order #:

No Units: 40

Parlour Type:

Swiftflo Revolver - Clockwise

TABLE ROLLER SET OUT

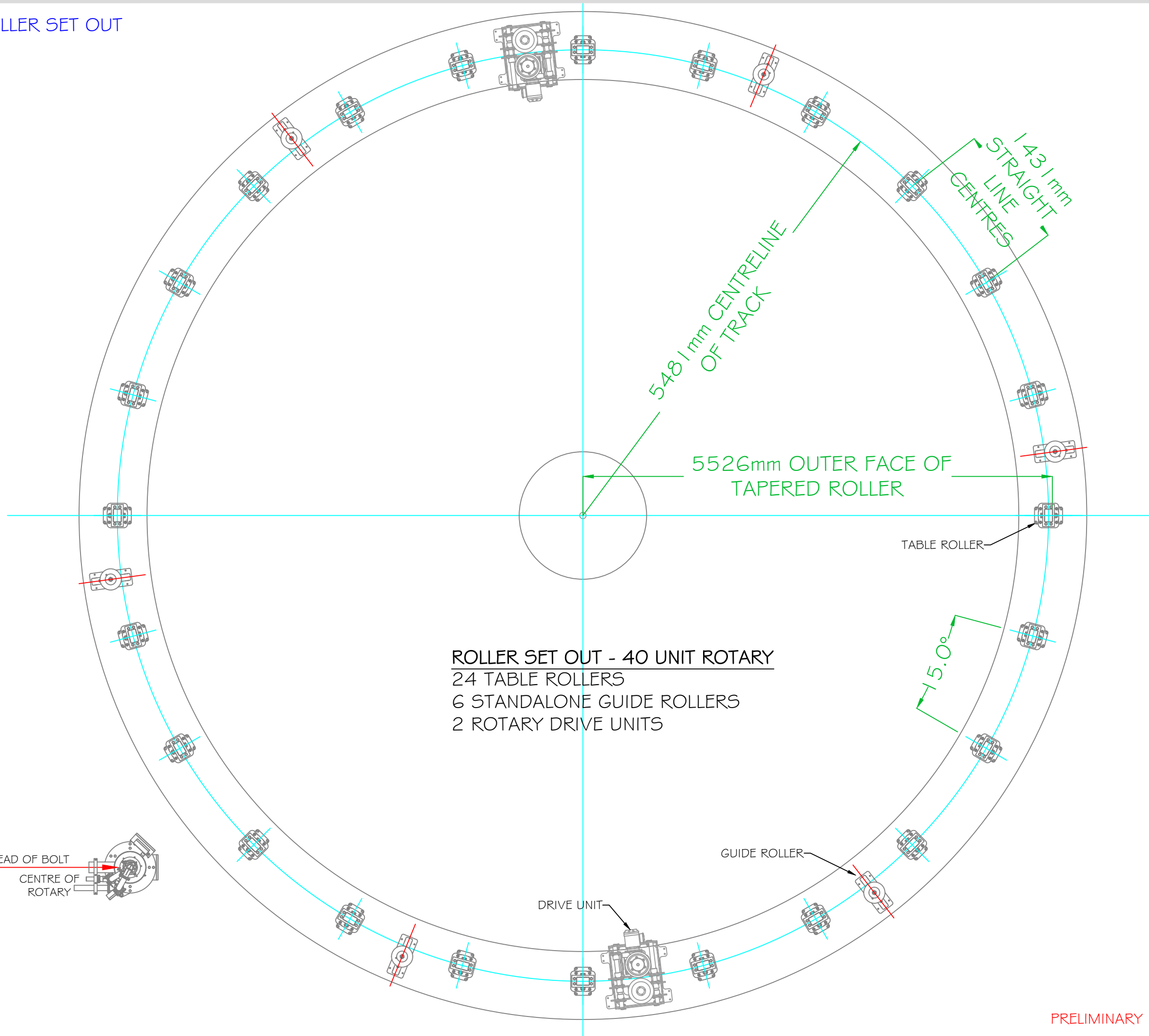

**ROLLER SET OUT - 40 UNIT ROTARY**  
 24 TABLE ROLLERS  
 6 STANDALONE GUIDE ROLLERS  
 2 ROTARY DRIVE UNITS

PRELIMINARY

**IMPORTANT**  
 Compliance with construction regulations applicable to this project is the sole and exclusive responsibility of the client. Compliance with health and safety regulations applicable to this project is the sole and exclusive responsibility of the client. The appointment of a principal designer applicable to this project and in compliance with regulations is the sole and exclusive responsibility of the client.

These plans and constructed facility are subject to various building codes, standards, ordinances and regulations. Compliance with such codes, standards, ordinances and regulations is your sole and exclusive responsibility. Prior to beginning any construction all dimensions and specifications should be examined and approved by a locally registered engineer and architect.

These plans are furnished as one example of a milking system. The system depicted may not be the most efficient or economical for you. DairyMaster makes no representation of or warranties, expressed or implied as to the efficiency of the system depicted in these plans or its appropriateness for use in your dairy business.

It is your responsibility to conduct a safety risk assessment & ensure safe systems of work on this facility both during construction & operation. These drawings may be only used for locating equipment for installation, all structural design, equipotential bonding and other functional requirements shall be the responsibility of the client.

DairyMaster accepts no responsibility for errors and omissions.

**NOTES:**

- Do not scale.
- Drainage and gullies in parlour, wash room and dairy to be positioned and installed by builder.
- Ensure all post are vertical and plum.
- Double check that the post measurements are correct at both the top and cow stand.
- 1.5% Slope = 1 IN 66.67
- 2.5% Slope = 1 IN 40

**NOTE:**

Production of parlour cannot commence until the drawings are confirmed

**DAIRYMASTER**

Experience the difference  
[www.dairymaster.com](http://www.dairymaster.com)  
 Tel: +353 66 7131124  
 Email: [design@dairymaster.com](mailto:design@dairymaster.com)

**OHZ Garzyn**  
 Leszczynska 34  
 62-120  
 Garzyn

Country: Poland

Dealer or Sales Rep:  
 DairyMaster BV

Drawing Number: PD00-001022-000.dwg	Rev: R1 Sht No: 16
--	-----------------------

Drawn By: Padraig Harty

Sales Order #:

No Units: 40

Parlour Type:

Swiftflo Revolver - Clockwise

# ELECTRICAL LAYOUT

## DAIRYMASTER GMBH, GERMANY 40 UNIT ROTARY PARLOUR 3 PHASE, 380 V - 420 V, AC, 50 HZ

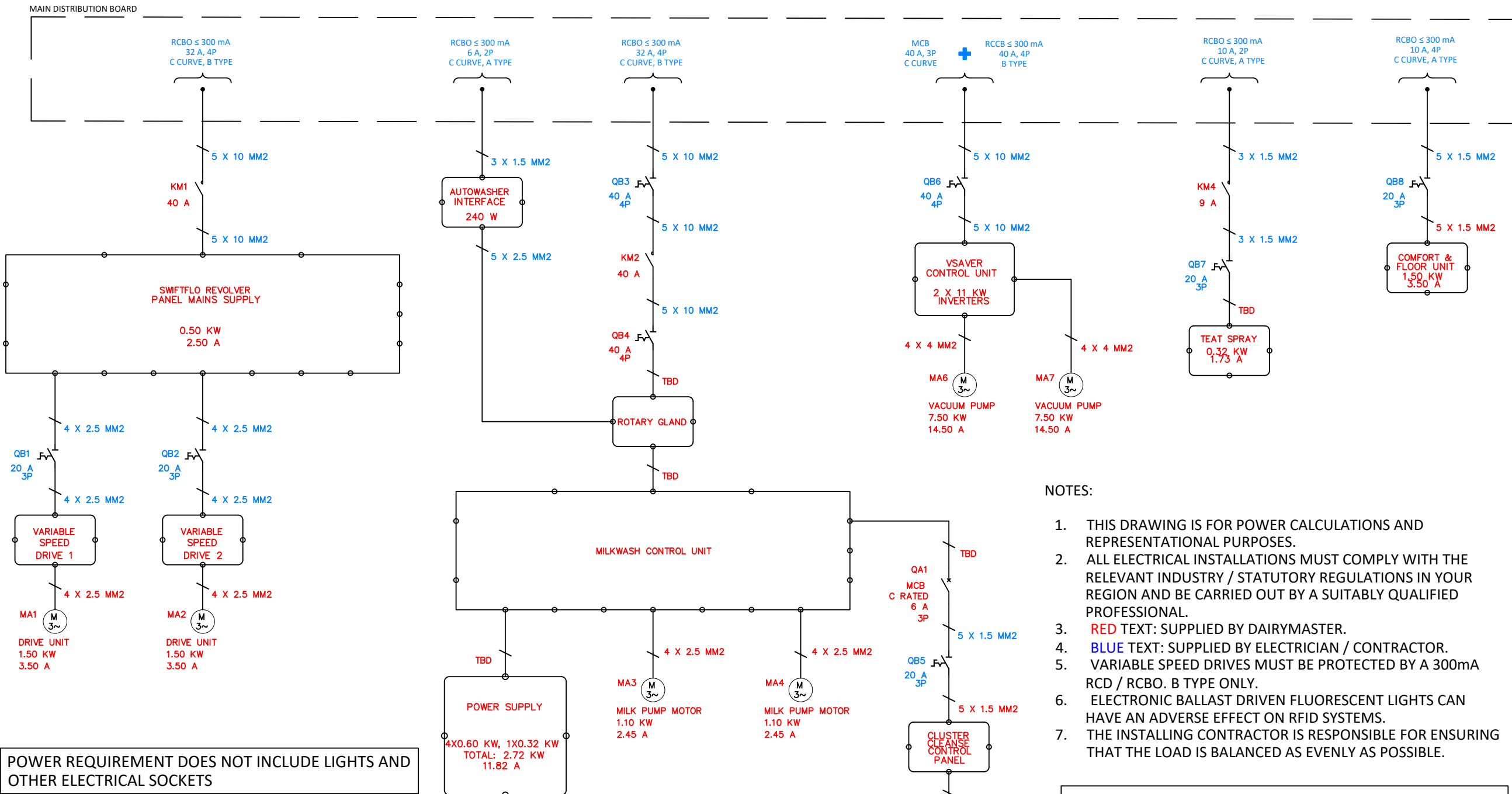

POWER REQUIREMENT DOES NOT INCLUDE LIGHTS AND OTHER ELECTRICAL SOCKETS

POWER REQUIREMENT							
DESCRIPTION	QTY	kW / UNIT	kW TOTAL	PHASE	VOLTAGE	AMPS / UNIT	AMPS TOTAL
SWIFTFLO REVOLVER PANEL	1	0.50	0.50	3	400	2.50	2.50
MILK PUMPS	2	1.10	2.20	3	400	2.45	4.90
CLUSTER CLEANSE	1	1.10	1.10	3	400	2.45	2.45
DRIVE UNIT	2	1.50	3.00	3	400	3.50	7.00
POWER SUPPLY	1	2.72	2.72	1	230	11.82	11.82
VACUUM PUMP	2	7.50	15.00	3	400	14.50	29.00
COMFORT FLOOR	1	1.50	1.50	3	400	3.50	3.50
TEAT SPRAY	1	0.32	0.32	1	230	1.73	1.73
AUTOWASHER & OTHER	1	1.00	1.00	1	230	4.50	4.50
<b>TOTAL</b>			<b>27.34</b>				<b>67.40</b>

### NOTES:

- THIS DRAWING IS FOR POWER CALCULATIONS AND REPRESENTATIONAL PURPOSES.
- ALL ELECTRICAL INSTALLATIONS MUST COMPLY WITH THE RELEVANT INDUSTRY / STATUTORY REGULATIONS IN YOUR REGION AND BE CARRIED OUT BY A SUITABLY QUALIFIED PROFESSIONAL.
- RED TEXT: SUPPLIED BY DAIRYMASTER.
- BLUE TEXT: SUPPLIED BY ELECTRICIAN / CONTRACTOR.
- VARIABLE SPEED DRIVES MUST BE PROTECTED BY A 300mA RCD / RCBO. B TYPE ONLY.
- ELECTRONIC BALLAST DRIVEN FLUORESCENT LIGHTS CAN HAVE AN ADVERSE EFFECT ON RFID SYSTEMS.
- THE INSTALLING CONTRACTOR IS RESPONSIBLE FOR ENSURING THAT THE LOAD IS BALANCED AS EVENLY AS POSSIBLE.

THIS IS A COLOUR DRAWING

SYMBOL DESIGNATORS	
DESIGNATOR	COMPONENT
QA	MCB / RCD / RCBO
KM	CONTACTOR
QB	ISOLATOR, MIN. IP55
MA	MOTOR

PRELIMINARY

**IMPORTANT**  
Compliance with construction regulations applicable to this project is the sole and exclusive responsibility of the client. Compliance with health and safety regulations applicable to this project is the sole and exclusive responsibility of the client. The appointment of a principal designer applicable to this project and in compliance with regulations is the sole and exclusive responsibility of the client.

These plans and constructed facility are subject to various building codes, standards, ordinances and regulations. Compliance with such codes, standards, ordinances and regulations is your sole and exclusive responsibility. Prior to beginning any construction all dimensions and specifications should be examined and approved by a locally registered engineer and architect.

These plans are furnished as one example of a milking system. The system depicted may not be the most efficient or economical for you. DairyMaster makes no representation of or warranties, expressed or implied as to the efficiency of the system depicted in these plans or its appropriateness for use in your dairy business.

It is your responsibility to conduct a safety risk assessment & ensure safe systems of work on this facility both during construction & operation. These drawings may be only used for locating equipment for installation, all structural design, equipotential bonding and other functional requirements shall be the responsibility of the client.

DairyMaster accepts no responsibility for errors and omissions.

### NOTES:

- Do not scale.
- Drainage and gullies in parlour, wash room and dairy to be positioned and installed by builder.
- Ensure all post are vertical and plum.
- Double check that the post measurements are correct at both the top and cow stand.
- 1.5% Slope = 1 IN 66.67
- 2.5% Slope = 1 IN 40

### NOTE:

Production of parlour cannot commence until the drawings are confirmed

**DAIRYMASTER**  
Experience the difference  
www.dairyMaster.com  
Tel: +353 66 7131124  
Email: design@dairyMaster.com

**OHZ Garzyn**  
Leszczynska 34  
62-120  
Garzyn

Country: Poland

Dealer or Sales Rep:  
DairyMaster BV

Drawing Number: PD00-001022-000.dwg  
Rev: R1  
Sht No: 17

Drawn By: Padraig Harty

Sales Order #:

No Units: 40

Parlour Type:  
Swiftflo Revolver - Clockwise